

DIMENSIONAL SPECIFICATIONS

LEAD-FREE DOMESTIC BRASS FITTINGS* 125 LB.

90 DEGREE ELBOW

| Part # | Size (IN.) | Approx. Net WT. (LB.) | A | B |
|----------|------------|-----------------------|------|------|
| NL101-02 | 1/8 | 0.06 | 0.54 | 0.54 |
| NL101-04 | 1/4 | 0.08 | 0.71 | 0.71 |
| NL101-06 | 3/8 | 0.16 | 0.82 | 0.82 |
| NL101-08 | 1/2 | 0.24 | 1.01 | 1.01 |
| NL101-12 | 3/4 | 0.35 | 1.18 | 1.18 |
| NL101-16 | 1 | 0.60 | 1.43 | 1.43 |
| NL101-20 | 1-1/4 | 0.95 | 1.69 | 1.69 |
| NL101-24 | 1-1/2 | 1.03 | 1.84 | 1.84 |
| NL101-32 | 2 | 1.95 | 2.12 | 2.12 |
| NL101-40 | 2-1/2 | 3.45 | 2.70 | 2.70 |
| NL101-48 | 3 | 5.40 | 3.08 | 3.08 |
| NL101-64 | 4 | 9.25 | 3.79 | 3.79 |
| NL101-96 | 6 | 24.22 | 5.13 | 5.13 |

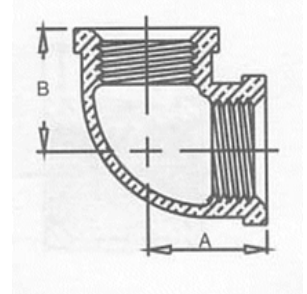

90 DEGREE STREET ELBOW

| Part # | Size (IN.) | Approx. Net WT. (LB.) | A | B |
|----------|------------|-----------------------|------|------|
| NL103-02 | 1/8 | 0.06 | 0.55 | 0.92 |
| NL103-04 | 1/4 | 0.11 | 0.72 | 1.11 |
| NL103-06 | 3/8 | 0.17 | 0.83 | 1.24 |
| NL103-08 | 1/2 | 0.23 | 1.03 | 1.51 |
| NL103-12 | 3/4 | 0.35 | 1.19 | 1.66 |
| NL103-16 | 1 | 0.50 | 1.43 | 1.98 |
| NL103-20 | 1-1/4 | 0.85 | 1.71 | 2.26 |
| NL103-24 | 1-1/2 | 1.15 | 1.87 | 2.46 |
| NL103-32 | 2 | 1.98 | 2.14 | 2.98 |
| NL103-40 | 2-1/2 | 3.15 | 2.74 | 3.92 |
| NL103-48 | 3 | 5.26 | 3.10 | 4.45 |

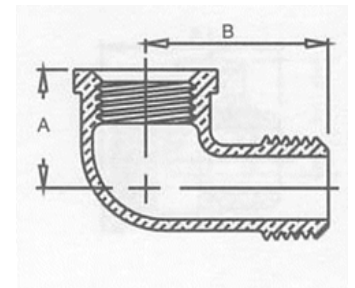

*Conforms with lead content requirements for lead-free plumbing as defined by the U.S. Safe Drinking Water Act. Certified <0.25 weighted average % lead.



MERIT BRASS

DIRECTING THE FLOW OF *Quality*

DIMENSIONAL SPECIFICATIONS

LEAD-FREE DOMESTIC BRASS FITTINGS* 125 LB.

90 DEGREE REDUCING ELBOW

| Part # | Size (IN.) | Approx. Net WT. (LB.) | A | B |
|------------|---------------|-----------------------|------|------|
| NL101-0402 | 1/4 X 1/8 | 0.09 | 0.65 | 0.60 |
| NL101-0602 | 3/8 X 1/8 | 0.14 | 0.67 | 1.00 |
| NL101-0604 | 3/8 X 1/4 | 0.13 | 0.75 | 0.75 |
| NL101-0804 | 1/2 X 1/4 | 0.17 | 1.78 | 1.69 |
| NL101-0806 | 1/2 X 3/8 | 0.18 | 0.93 | 0.90 |
| NL101-1204 | 3/4 X 1/4 | 0.30 | 1.00 | 1.00 |
| NL101-1206 | 3/4 X 3/8 | 0.25 | 0.97 | 0.97 |
| NL101-1208 | 3/4 X 1/2 | 0.31 | 1.08 | 1.11 |
| NL101-1608 | 1 X 1/2 | 0.45 | 1.20 | 1.24 |
| NL101-1612 | 1 X 3/4 | 0.50 | 1.30 | 1.31 |
| NL101-2008 | 1-1/4 X 1/2 | 0.70 | 1.25 | 1.38 |
| NL101-2412 | 1-1/4 X 3/4 | 0.88 | 1.30 | 1.31 |
| NL101-2016 | 1-1/4 X 1 | 0.82 | 1.52 | 1.60 |
| NL101-2416 | 1-1/2 X 1 | 0.96 | 1.55 | 1.72 |
| NL101-2420 | 1-1/2 X 1-1/4 | 1.00 | 1.72 | 1.81 |
| NL101-3208 | 2 X 1/2 | 1.25 | 1.17 | 2.92 |
| NL101-3216 | 2 X 1 | 1.60 | 1.56 | 1.94 |
| NL101-3224 | 2 X 1-1/2 | 1.78 | 1.89 | 2.07 |
| NL101-4024 | 2-1/2 X 1-1/2 | 3.28 | 2.19 | 2.50 |
| NL101-4032 | 2-1/2 X 2 | 3.02 | 2.39 | 2.60 |

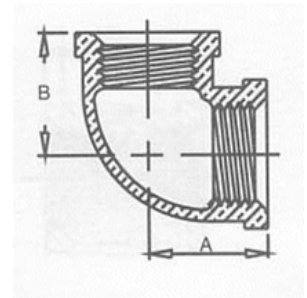

*Conforms with lead content requirements for lead-free plumbing as defined by the U.S. Safe Drinking Water Act. Certified <0.25 weighted average % lead.



MERIT BRASS

DIRECTING THE FLOW OF *Quality*

DIMENSIONAL SPECIFICATIONS

LEAD-FREE DOMESTIC BRASS FITTINGS* 125 LB.

45 DEGREE ELBOW

| Part # | Size (IN.) | Approx. Net WT. (LB.) | A | B |
|----------|------------|-----------------------|------|------|
| NL102-02 | 1/8 | 0.05 | 0.43 | 0.43 |
| NL102-04 | 1/4 | 0.09 | 0.55 | 0.55 |
| NL102-06 | 3/8 | 1.14 | 0.63 | 0.63 |
| NL102-08 | 1/2 | 0.19 | 0.79 | 0.79 |
| NL102-12 | 3/4 | 0.30 | 0.91 | 0.91 |
| NL102-16 | 1 | 0.50 | 1.07 | 1.07 |
| NL102-20 | 1-1/4 | 0.75 | 1.23 | 1.23 |
| NL102-24 | 1-1/2 | 0.95 | 1.31 | 1.31 |
| NL102-32 | 2 | 1.70 | 1.47 | 1.47 |
| NL102-40 | 2-1/2 | 2.79 | 1.89 | 1.89 |

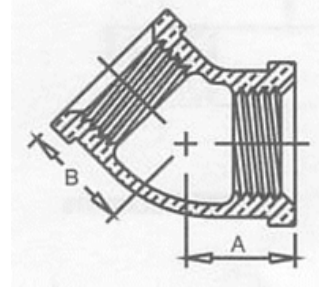

45 DEGREE STREET ELBOW

| Part # | Size (IN.) | Approx. Net WT. (LB.) | A | B |
|-----------|------------|-----------------------|------|------|
| NL103A-04 | 1/4 | 0.08 | 0.56 | 0.88 |
| NL103A-06 | 3/8 | 0.12 | 0.63 | 0.92 |
| NL103A-08 | 1/2 | 0.17 | 0.78 | 1.06 |
| NL103A-12 | 3/4 | 0.29 | 0.89 | 1.23 |
| NL103A-16 | 1 | 0.49 | 1.06 | 1.40 |
| NL103A-20 | 1-1/4 | 0.70 | 1.22 | 1.64 |
| NL103A-24 | 1-1/2 | 0.92 | 1.30 | 1.80 |
| NL103A-32 | 2 | 1.37 | 1.45 | 2.14 |

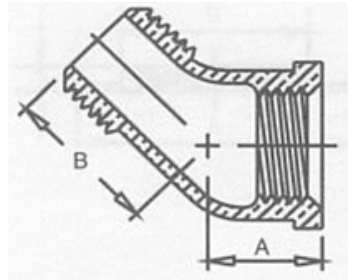

*Conforms with lead content requirements for lead-free plumbing as defined by the U.S. Safe Drinking Water Act. Certified <0.25 weighted average % lead.



MERIT BRASS

DIRECTING THE FLOW OF *Quality*

DIMENSIONAL SPECIFICATIONS

LEAD-FREE DOMESTIC BRASS FITTINGS* 125 LB.

45 DEGREE Y-BRANCH

| Part # | Size (IN.) | Approx. Net WT. (LB.) | A | B |
|----------|------------|-----------------------|------|------|
| NL122-06 | 3/8 | 0.28 | 1.78 | 1.28 |
| NL122-08 | 1/2 | 0.29 | 2.19 | 1.58 |
| NL122-12 | 3/4 | 0.62 | 2.62 | 1.90 |
| NL122-16 | 1 | 0.97 | 3.18 | 2.33 |
| NL122-20 | 1-1/4 | 1.63 | 3.85 | 2.83 |
| NL122-24 | 1-1/2 | 1.96 | 4.24 | 3.14 |
| NL122-32 | 2 | 3.25 | 5.00 | 3.76 |
| NL122-40 | 2-1/2 | 6.39 | 6.25 | 4.75 |
| NL122-48 | 3 | 10.19 | 7.25 | 5.56 |

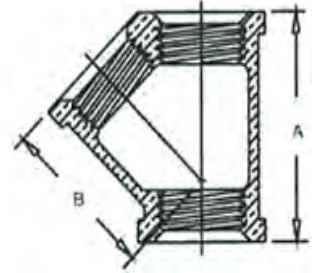

*Conforms with lead content requirements for lead-free plumbing as defined by the U.S. Safe Drinking Water Act. Certified <0.25 weighted average % lead.



MERIT BRASS

DIRECTING THE FLOW OF *Quality*

DIMENSIONAL SPECIFICATIONS

LEAD-FREE DOMESTIC BRASS FITTINGS* 125 LB.

TEE

| Part # | Size (IN.) | Approx. Net WT. (LB.) | A | B | C |
|----------|------------|-----------------------|------|------|------|
| NL106-02 | 1/8 | 0.07 | 0.54 | 0.54 | 0.54 |
| NL106-04 | 1/4 | 0.14 | 0.71 | 0.71 | 0.71 |
| NL106-06 | 3/8 | 0.21 | 0.82 | 0.82 | 0.82 |
| NL106-08 | 1/2 | 0.30 | 1.01 | 1.01 | 1.01 |
| NL106-12 | 3/4 | 0.50 | 1.18 | 1.18 | 1.18 |
| NL106-16 | 1 | 0.80 | 1.43 | 1.43 | 1.43 |
| NL106-20 | 1-1/4 | 1.47 | 1.69 | 1.69 | 1.69 |
| NL106-24 | 1-1/2 | 1.50 | 1.84 | 1.84 | 1.84 |
| NL106-32 | 2 | 2.25 | 2.12 | 2.12 | 2.12 |
| NL106-40 | 2-1/2 | 4.56 | 2.70 | 2.70 | 2.70 |
| NL106-48 | 3 | 6.70 | 3.08 | 3.08 | 3.08 |
| NL106-64 | 4 | 11.03 | 3.79 | 3.79 | 3.79 |

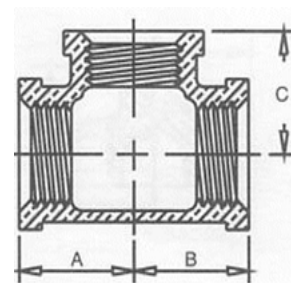

STREET TEE

| Part # | Size (IN.) | Approx. Net WT. (LB.) | A | B |
|-----------|------------|-----------------------|------|------|
| NL106A-08 | 1/2 | 0.27 | 2.19 | 1.59 |
| NL106A-32 | 2 | 3.20 | 2.13 | 2.88 |

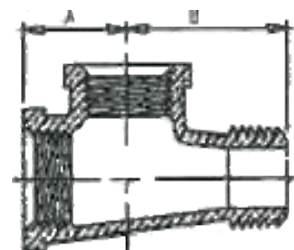

*Conforms with lead content requirements for lead-free plumbing as defined by the U.S. Safe Drinking Water Act. Certified <0.25 weighted average % lead.



MERIT BRASS

DIRECTING THE FLOW OF *Quality*

DIMENSIONAL SPECIFICATIONS

LEAD-FREE DOMESTIC BRASS FITTINGS* 125 LB.

REDUCING TEE

| Part # | Size (IN.) | Approx. Net WT. (LB.) | A | B | C |
|--------------|---------------------|-----------------------|------|------|------|
| NL106-060604 | 3/8 X 3/8 X 1/4 | 0.17 | 0.75 | 0.75 | 0.78 |
| NL106-060608 | 3/8 X 3/8 X 1/2 | 0.24 | 0.90 | 0.90 | 0.93 |
| NL106-080408 | 1/2 X 1/4 X 1/2 | 0.27 | 0.93 | 0.87 | 0.93 |
| NL106-080606 | 1/2 X 3/8 X 3/8 | 0.25 | 0.93 | 0.82 | 0.90 |
| NL106-080608 | 1/2 X 3/8 X 1/2 | 0.25 | 1.01 | 0.90 | 1.01 |
| NL106-080806 | 1/2 X 1/2 X 3/8 | 0.25 | 0.93 | 0.93 | 0.90 |
| NL106-080812 | 1/2 X 1/2 X 3/4 | 0.38 | 1.11 | 1.11 | 1.08 |
| NL106-120808 | 3/4 X 1/2 X 1/2 | 0.42 | 1.08 | 1.01 | 1.11 |
| NL106-120812 | 3/4 X 1/2 X 3/4 | 0.42 | 1.18 | 1.11 | 1.18 |
| NL106-121204 | 3/4 X 3/4 X 1/4 | 0.35 | 1.00 | 1.00 | 1.00 |
| NL106-121208 | 3/4 X 3/4 X 1/2 | 0.40 | 1.08 | 1.08 | 1.11 |
| NL106-121216 | 3/4 X 3/4 X 1 | 0.60 | 1.31 | 1.31 | 1.30 |
| NL106-160816 | 1 X 1/2 X 1 | 0.61 | 1.43 | 1.24 | 1.43 |
| NL106-161208 | 1 X 3/4 X 1/2 | 0.46 | 1.20 | 1.08 | 1.24 |
| NL106-161212 | 1 X 3/4 X 3/4 | 0.58 | 1.30 | 1.08 | 1.31 |
| NL106-161216 | 1 X 3/4 X 1 | 0.71 | 1.43 | 1.31 | 1.43 |
| NL106-161606 | 1 X 1 X 3/8 | 0.56 | 1.12 | 1.12 | 1.13 |
| NL106-161608 | 1 X 1 X 1/2 | 0.63 | 1.20 | 1.20 | 1.24 |
| NL106-161612 | 1 X 1 X 3/4 | 0.72 | 1.30 | 1.30 | 1.31 |
| NL106-202008 | 1-1/4 X 1-1/4 X 1/2 | 0.92 | 1.29 | 1.29 | 1.41 |
| NL106-202012 | 1-1/4 X 1-1/4 X 3/4 | 0.91 | 1.39 | 1.39 | 1.48 |
| NL106-202016 | 1-1/4 X 1-1/4 X 1 | 1.10 | 1.52 | 1.52 | 1.60 |

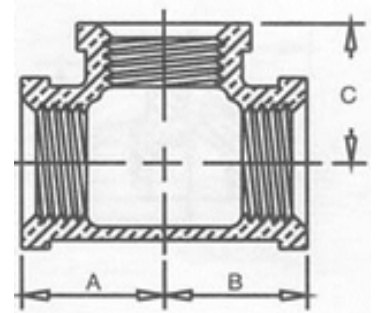

*Conforms with lead content requirements for lead-free plumbing as defined by the U.S. Safe Drinking Water Act. Certified <0.25 weighted average % lead.



MERIT BRASS

DIRECTING THE FLOW OF *Quality*

DIMENSIONAL SPECIFICATIONS

LEAD-FREE DOMESTIC BRASS FITTINGS* 125 LB.

REDUCING TEE CONTINUED

| Part # | Size (IN.) | Approx. Net WT. (LB.) | A | B | C |
|--------------|-----------------------|-----------------------|------|------|------|
| NL106-202024 | 1-1/4 X 1-1/4 X 1-1/2 | 1.74 | 1.81 | 1.81 | 1.72 |
| NL106-240824 | 1-1/2 X 1/2 X 1-1/2 | 1.51 | 1.81 | 1.56 | 1.81 |
| NL106-241224 | 1-1/2 X 3/4 X 1-1/2 | 1.35 | 1.84 | 1.60 | 1.84 |
| NL106-241616 | 1-1/2 X 1 X 1 | 1.10 | 1.63 | 1.50 | 1.81 |
| NL106-241624 | 1-1/2 X 1 X 1-1/2 | 1.47 | 1.88 | 1.81 | 1.88 |
| NL106-242408 | 1-1/2 X 1-1/2 X 1/2 | 1.17 | 1.32 | 1.32 | 1.53 |
| NL106-242412 | 1-1/2 X 1-1/2 X 3/4 | 1.14 | 1.42 | 1.42 | 1.60 |
| NL106-242416 | 1-1/2 X 1-1/2 X 1 | 1.35 | 1.55 | 1.55 | 1.72 |
| NL106-242420 | 1-1/2 X 1-1/2 X 1-1/4 | 1.45 | 1.72 | 1.72 | 1.81 |
| NL106-242432 | 1-1/2 X 1-1/2 X 2 | 2.15 | 2.07 | 2.07 | 1.89 |
| NL106-321232 | 2 X 3/4 X 2 | 2.56 | 2.13 | 1.84 | 2.13 |
| NL106-322420 | 2 X 1-1/2 X 1-1/4 | 1.79 | 1.78 | 1.72 | 2.03 |
| NL106-323208 | 2 X 2 X 1/2 | 1.67 | 1.50 | 1.50 | 1.88 |
| NL106-323212 | 2 X 2 X 3/4 | 1.70 | 1.47 | 1.47 | 1.84 |
| NL106-323216 | 2 X 2 X 1 | 1.83 | 1.59 | 1.59 | 1.95 |
| NL106-323220 | 2 X 2 X 1-1/4 | 2.07 | 1.77 | 1.77 | 2.04 |
| NL106-323224 | 2 X 2 X 1-1/2 | 2.18 | 1.89 | 1.89 | 2.07 |
| NL106-403240 | 2-1/2 X 2 X 2-1/2 | 4.18 | 2.69 | 2.63 | 2.69 |
| NL106-404016 | 2-1/2 X 2-1/2 X 1 | 2.98 | 1.88 | 1.88 | 2.38 |
| NL106-404032 | 2-1/2 X 2-1/2 X 2 | 3.91 | 2.39 | 2.39 | 2.60 |
| NL106-484832 | 3 X 3 X 2 | 5.61 | 2.52 | 2.52 | 2.89 |

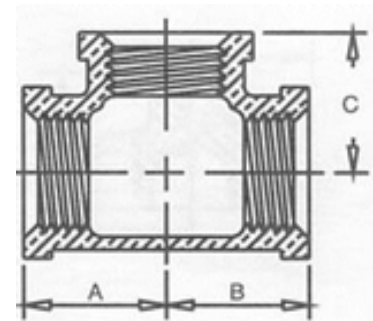

*Conforms with lead content requirements for lead-free plumbing as defined by the U.S. Safe Drinking Water Act. Certified <0.25 weighted average % lead.



MERIT BRASS

DIRECTING THE FLOW OF *Quality*

DIMENSIONAL SPECIFICATIONS

LEAD-FREE DOMESTIC BRASS FITTINGS* 125 LB.

CROSS

| Part # | Size (IN.) | Approx. Net WT. (LB.) | A | B |
|----------|------------|-----------------------|------|------|
| NL110-04 | 1/4 | 0.16 | 0.71 | 0.71 |
| NL110-06 | 3/8 | 0.23 | 0.82 | 0.82 |
| NL110-08 | 1/2 | 0.34 | 1.01 | 1.01 |
| NL110-12 | 3/4 | 0.55 | 1.18 | 1.18 |
| NL110-16 | 1 | 0.95 | 1.43 | 1.43 |
| NL110-20 | 1-1/4 | 1.94 | 1.69 | 1.69 |
| NL110-24 | 1-1/2 | 2.95 | 1.84 | 1.84 |
| NL110-32 | 2 | 7.84 | 2.12 | 2.12 |

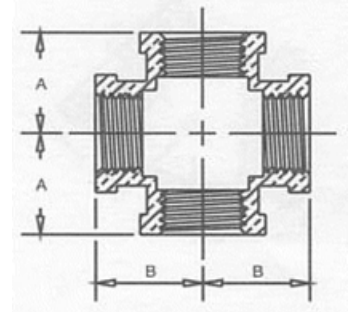

CAP

| Part # | Size (IN.) | Approx. Net WT. (LB.) | A |
|----------|------------|-----------------------|------|
| NL116-02 | 1/8 | 0.04 | 0.49 |
| NL116-04 | 1/4 | 0.07 | 0.59 |
| NL116-06 | 3/8 | 0.10 | 0.66 |
| NL116-08 | 1/2 | 0.12 | 0.78 |
| NL116-12 | 3/4 | 0.21 | 0.84 |
| NL116-16 | 1 | 0.30 | 1.00 |
| NL116-20 | 1-1/4 | 0.45 | 1.13 |
| NL116-24 | 1-1/2 | 0.65 | 1.16 |
| NL116-32 | 2 | 1.10 | 1.34 |
| NL116-40 | 2-1/2 | 1.79 | 1.72 |
| NL116-48 | 3 | 1.78 | 1.81 |
| NL116-64 | 4 | 5.59 | 2.09 |

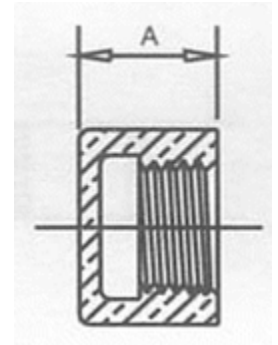

*Conforms with lead content requirements for lead-free plumbing as defined by the U.S. Safe Drinking Water Act. Certified <0.25 weighted average % lead.



MERIT BRASS

DIRECTING THE FLOW OF *Quality*

DIMENSIONAL SPECIFICATIONS

LEAD-FREE DOMESTIC BRASS FITTINGS* 125 LB.

COUPLING

| Part # | Size (IN.) | Approx. Net WT. (LB.) | A |
|----------|------------|-----------------------|------|
| NL111-02 | 1/8 | 0.06 | 0.80 |
| NL111-04 | 1/4 | 0.08 | 0.80 |
| NL111-06 | 3/8 | 0.12 | 1.05 |
| NL111-08 | 1/2 | 0.25 | 1.29 |
| NL111-12 | 3/4 | 0.30 | 1.43 |
| NL111-16 | 1 | 0.45 | 1.68 |
| NL111-20 | 1-1/4 | 0.65 | 1.86 |
| NL111-24 | 1-1/2 | 0.90 | 1.92 |
| NL111-32 | 2 | 1.35 | 2.20 |
| NL111-40 | 2-1/2 | 2.40 | 2.88 |
| NL111-48 | 3 | 3.45 | 3.18 |
| NL111-64 | 4 | 5.03 | 3.69 |

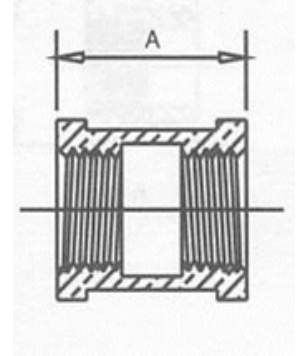

*Conforms with lead content requirements for lead-free plumbing as defined by the U.S. Safe Drinking Water Act. Certified <0.25 weighted average % lead.



MERIT BRASS

DIRECTING THE FLOW OF *Quality*

DIMENSIONAL SPECIFICATIONS

LEAD-FREE DOMESTIC BRASS FITTINGS* 125 LB.

REDUCING COUPLING

| Part # | Size (IN.) | Approx. Net WT. (LB.) | A |
|------------|---------------|-----------------------|-------|
| NL112-0604 | 3/8 X 1/4 | 0.09 | 0.92 |
| NL112-0804 | 1/2 X 1/4 | 0.135 | 1.13 |
| NL112-0806 | 1/2 X 3/8 | 0.16 | 1.17 |
| NL112-1206 | 3/4 X 3/8 | 0.23 | 1.35 |
| NL112-1208 | 3/4 X 1/2 | 0.25 | 1.35 |
| NL112-1612 | 1 X 3/4 | 0.35 | 1.56 |
| NL112-2012 | 1-1/4 X 3/4 | 0.62 | 1.77 |
| NL112-2408 | 1-1/2 X 1/2 | 0.59 | 1.80 |
| NL112-2412 | 1-1/2 X 3/4 | 0.65 | 1.80 |
| NL112-2416 | 1-1/2 X 1 | 0.60 | 1.80 |
| NL112-2420 | 1-1/2 X 1-1/4 | 0.75 | 1.80 |
| NL112-3216 | 2 X 1 | 1.00 | 2.03 |
| NL112-3220 | 2 X 1-1/4 | 1.05 | 2.03 |
| NL112-3224 | 2 X 1-1/2 | 1.115 | 2.085 |
| NL112-4032 | 2-1/2 X 2 | 1.71 | 3.25 |
| NL112-4832 | 3 X 2 | 2.70 | 3.69 |
| NL112-4840 | 3 X 2-1/2 | 3.33 | 3.69 |
| NL112-6432 | 4 X 2 | 4.29 | 4.38 |

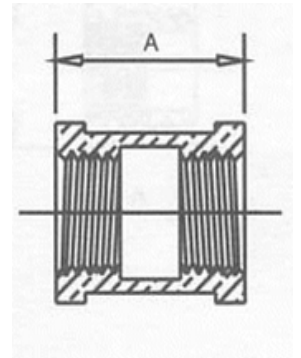

*Conforms with lead content requirements for lead-free plumbing as defined by the U.S. Safe Drinking Water Act. Certified <0.25 weighted average % lead.



MERIT BRASS

DIRECTING THE FLOW OF *Quality*

DIMENSIONAL SPECIFICATIONS

LEAD-FREE DOMESTIC BRASS FITTINGS* 125 LB.

HEX BUSHING

| Part # | Size (IN.) | Approx. Net WT. (LB.) | A | B | C | D |
|------------|-------------|-----------------------|------|------|------|------|
| NL114-0802 | 1/2 X 1/8 | 0.09 | 0.75 | 0.56 | 0.50 | 0.88 |
| NL114-0804 | 1/2 X 1/4 | 0.10 | 0.75 | 0.56 | 0.43 | 0.88 |
| NL114-0806 | 1/2 X 3/8 | 0.06 | 0.75 | 0.56 | 0.34 | 0.88 |
| NL114-1202 | 3/4 X 1/8 | 0.14 | 0.88 | 0.63 | 0.25 | 1.16 |
| NL114-1204 | 3/4 X 1/4 | 0.15 | 0.85 | 0.63 | 0.53 | 1.16 |
| NL114-1206 | 3/4 X 3/8 | 0.14 | 0.85 | 0.63 | 0.49 | 1.16 |
| NL114-1208 | 3/4 X 1/2 | 0.11 | 0.85 | 0.63 | 0.32 | 1.16 |
| NL114-1602 | 1 X 1/8 | 0.22 | 1.06 | 0.75 | 0.75 | 1.44 |
| NL114-1604 | 1 X 1/4 | 0.25 | 1.05 | 0.75 | 0.73 | 1.44 |
| NL114-1606 | 1 X 3/8 | 0.20 | 1.05 | 0.75 | 0.69 | 1.13 |
| NL114-1608 | 1 X 1/2 | 0.25 | 1.00 | 0.75 | 0.57 | 1.13 |
| NL114-1612 | 1 X 3/4 | 0.19 | 1.00 | 0.75 | 0.50 | 1.13 |
| NL114-2008 | 1-1/4 X 1/2 | 0.40 | 1.14 | 0.80 | 0.71 | 1.34 |
| NL114-2012 | 1-1/4 X 3/4 | 0.43 | 1.1 | 0.80 | 0.64 | 1.76 |
| NL114-2016 | 1-1/4 X 1 | 0.30 | 1.08 | 0.80 | 0.47 | 1.78 |
| NL114-2412 | 1-1/2 X 3/4 | 0.50 | 1.20 | 0.83 | 0.70 | 1.63 |

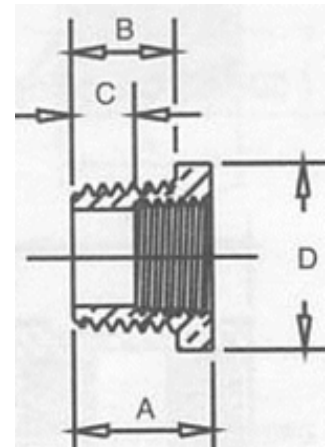

NOTE: Bushings reducing to pipe sizes smaller than given are bushed from the smallest reduction appearing in the table.



*Conforms with lead content requirements for lead-free plumbing as defined by the U.S. Safe Drinking Water Act. Certified <0.25 weighted average % lead.

MERIT BRASS

DIRECTING THE FLOW OF *Quality*

DIMENSIONAL SPECIFICATIONS

LEAD-FREE DOMESTIC BRASS FITTINGS* 125 LB.

HEX BUSHING CONTINUED

| Part # | Size (IN.) | Approx. Net WT. (LB.) | A | B | C | D |
|------------|---------------|-----------------------|------|------|------|------|
| NL114-2416 | 1-1/2 X 1 | 0.45 | 1.14 | 0.83 | 0.56 | 2.00 |
| NL114-2420 | 1-1/2 X 1-1/4 | 0.35 | 1.14 | 0.83 | 0.43 | 2.00 |
| NL114-3204 | 2 X 1/4 | 0.66 | 1.25 | 0.25 | 0.73 | 2.38 |
| NL114-3208 | 2 X 1/2 | 1.00 | 1.31 | 0.88 | 0.88 | 1.34 |
| NL114-3212 | 2 X 3/4 | 0.95 | 1.31 | 0.88 | 0.81 | 1.63 |
| NL114-3216 | 2 X 1 | 0.77 | 1.36 | 0.91 | 0.78 | 1.96 |
| NL114-3220 | 2 X 1-1/4 | 0.75 | 1.22 | 0.88 | 0.55 | 2.50 |
| NL114-3224 | 2 X 1-1/2 | 0.65 | 1.22 | 0.88 | 0.52 | 2.50 |
| NL114-4016 | 2-1/2 X 1 | 1.03 | 1.53 | 1.09 | 0.94 | 1.97 |
| NL114-4020 | 2-1/2 X 1-1/4 | 1.07 | 1.53 | 1.09 | 0.84 | 2.97 |
| NL114-4032 | 2-1/2 X 2 | 1.15 | 1.44 | 1.07 | 0.69 | 2.41 |
| NL114-4816 | 3 X 1 | 1.97 | 1.63 | 1.13 | 1.03 | 3.50 |
| NL114-4820 | 3 X 1-1/4 | 1.75 | 1.63 | 1.13 | 0.94 | 3.50 |
| NL114-4824 | 3 X 1-1/2 | 1.52 | 1.63 | 1.13 | 0.91 | 3.50 |
| NL114-4832 | 3 X 2 | 1.65 | 1.61 | 1.13 | 0.86 | 3.50 |
| NL114-4840 | 3 X 2-1/2 | 1.70 | 1.53 | 1.13 | 0.61 | 3.88 |

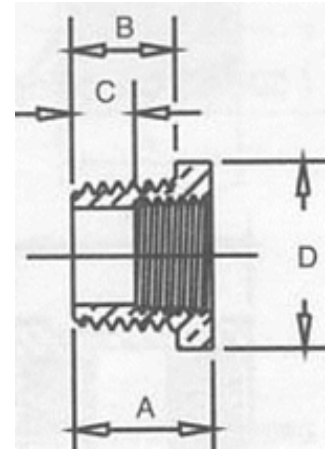

NOTE: Bushings reducing to pipe sizes smaller than given are bushed from the smallest reduction appearing in the table.



*Conforms with lead content requirements for lead-free plumbing as defined by the U.S. Safe Drinking Water Act. Certified <0.25 weighted average % lead.

MERIT BRASS

DIRECTING THE FLOW OF *Quality*

DIMENSIONAL SPECIFICATIONS

LEAD-FREE DOMESTIC BRASS FITTINGS* 125 LB.

SQUARE HEAD CORED PLUG

| Part # | Size (IN.) | Approx. Net WT. (LB.) | A | B | C |
|----------|------------|-----------------------|------|------|------|
| NL117-08 | 1/2 | 0.11 | 0.54 | 0.38 | 0.56 |
| NL117-12 | 3/4 | 0.15 | 0.55 | 0.44 | 0.63 |
| NL117-16 | 1 | 0.26 | 0.69 | 0.50 | 0.81 |
| NL117-20 | 1-1/4 | 0.35 | 0.71 | 0.56 | 0.94 |
| NL117-24 | 1-1/2 | 0.45 | 0.73 | 0.62 | 1.13 |
| NL117-32 | 2 | 0.60 | 0.76 | 0.68 | 1.31 |
| NL117-40 | 2-1/2 | 1.13 | 1.07 | 0.74 | 1.50 |
| NL117-48 | 3 | 1.90 | 1.13 | 0.80 | 1.69 |
| NL117-64 | 4 | 3.22 | 1.22 | 0.92 | 2.25 |

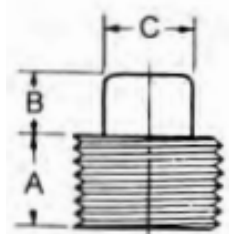

SQUARE HEAD SOLID PLUG

| Part # | Size (IN.) | Approx. Net WT. (LB.) | A | B | C |
|-----------|------------|-----------------------|------|------|------|
| NL117A-06 | 3/8 | 0.06 | 0.41 | 0.31 | 0.44 |
| NL117A-08 | 1/2 | 0.12 | 0.54 | 0.38 | 0.56 |
| NL117A-12 | 3/4 | 0.20 | 0.55 | 0.44 | 0.63 |
| NL117A-16 | 1 | 0.25 | 0.69 | 0.50 | 0.81 |
| NL117A-20 | 1-1/4 | 0.60 | 0.71 | 0.56 | 0.94 |
| NL117A-24 | 1-1/2 | 0.76 | 0.73 | 0.62 | 1.13 |
| NL117A-32 | 2 | 1.13 | 0.76 | 0.68 | 1.31 |
| NL117A-40 | 2-1/2 | 2.26 | 1.07 | 0.74 | 1.50 |

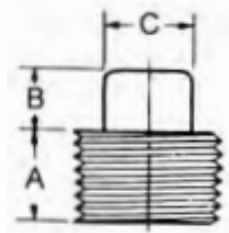

*Conforms with lead content requirements for lead-free plumbing as defined by the U.S. Safe Drinking Water Act. Certified <0.25 weighted average % lead.



MERIT BRASS

DIRECTING THE FLOW OF *Quality*

DIMENSIONAL SPECIFICATIONS

LEAD-FREE DOMESTIC BRASS FITTINGS* 125 LB.

SQUARE COUNTERSUNK PLUG

| Part # | Size (IN.) | Approx. Net WT. (LB.) | A |
|----------|------------|-----------------------|------|
| NL118-08 | 1/2 | 0.06 | 0.54 |
| NL118-12 | 3/4 | 0.09 | 0.55 |
| NL118-16 | 1 | 0.23 | 0.69 |
| NL118-20 | 1-1/4 | 0.34 | 0.71 |
| NL118-24 | 1-1/2 | 0.48 | 0.73 |
| NL118-32 | 2 | 0.80 | 0.76 |
| NL118-48 | 3 | 2.55 | 1.13 |

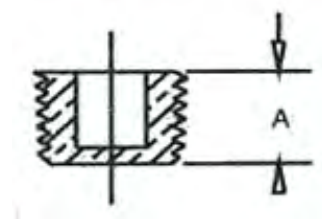

HEX LOCKNUT

| Part # | Size (IN.) | Approx. Net WT. (LB.) | A | B |
|----------|------------|-----------------------|------|------|
| NL119-02 | 1/8 | 0.04 | 0.88 | 0.25 |
| NL119-04 | 1/4 | 0.04 | 0.88 | 0.25 |
| NL119-06 | 3/8 | 0.03 | 1.00 | 0.28 |
| NL119-08 | 1/2 | 0.07 | 1.28 | 0.31 |
| NL119-12 | 3/4 | 0.08 | 1.50 | 0.28 |
| NL119-16 | 1 | 0.11 | 1.75 | 0.34 |
| NL119-20 | 1-1/4 | 0.17 | 2.09 | 0.38 |
| NL119-24 | 1-1/2 | 0.28 | 2.44 | 0.41 |
| NL119-48 | 3 | 1.70 | 4.25 | 0.63 |

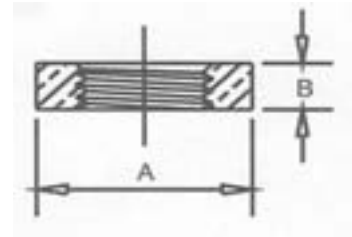

*Conforms with lead content requirements for lead-free plumbing as defined by the U.S. Safe Drinking Water Act. Certified <0.25 weighted average % lead.



MERIT BRASS

DIRECTING THE FLOW OF *Quality*

DIMENSIONAL SPECIFICATIONS

LEAD-FREE DOMESTIC BRASS FITTINGS* 125 LB.

EXTENSION PIECE

| Part # | Size (IN.) | Approx. Net WT. (LB.) | A |
|----------|------------|-----------------------|------|
| NL232-08 | 1/2 | 0.19 | 1.47 |
| NL232-12 | 3/4 | 0.26 | 1.81 |
| NL232-16 | 1 | 0.45 | 2.19 |

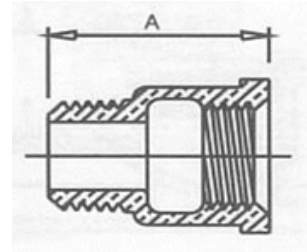

UNION

| Part # | Size (IN.) | Approx. Net WT. (LB.) | A |
|----------|------------|-----------------------|------|
| NL187-04 | 1/4 | 0.20 | 1.25 |
| NL187-06 | 3/8 | 0.30 | 1.48 |
| NL187-08 | 1/2 | 0.45 | 1.56 |
| NL187-12 | 3/4 | 0.62 | 1.87 |
| NL187-16 | 1 | 0.85 | 2.11 |
| NL187-20 | 1-1/4 | 1.40 | 2.34 |
| NL187-24 | 1-1/2 | 1.75 | 2.65 |
| NL187-32 | 2 | 2.75 | 2.96 |

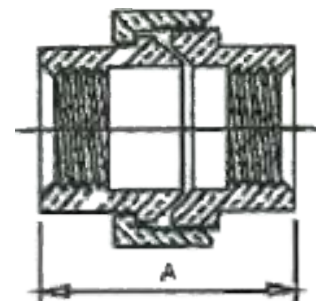

*Conforms with lead content requirements for lead-free plumbing as defined by the U.S. Safe Drinking Water Act. Certified <0.25 weighted average % lead.



MERIT BRASS

DIRECTING THE FLOW OF *Quality*