

IMPORT BRASS FITTINGS (LEAD-FREE)

Nominal Pipe Size

1/8" – 4"

Description

This specification covers Import Brass Fittings used in piping applications as determined by the End User as a function of what is being transported in the system, pressure ratings, temperature of ratings and line pressure.

Specifications

Import Brass Fittings (Lead Free) provided by Merit Brass Co. shall conform to ASME B16.15 (Cast Copper Alloy Threaded Fittings: Classes 125 and 150) from Copper Alloy C89833 that is in accordance with ASTM B584 (Standard Specification for Copper Alloy Sand Castings for General Applications). Fittings are threaded with American Standard Tapered Pipe Threads (NPT) in accordance with ASME B1.20.1 (Pipe Threads, General Purpose).

Certification

- NSF/ANSI/CAN 61 Drinking Water System Components – Health Effects
- NSF/ANSI/CAN 372 Drinking Water System Components – Lead Content

Fitting Type

- 45° Elbow
- 45° Street Elbow
- 90° Elbow
- 90° Street Elbow
- 90° Reducing Elbow
- Tee
- Reducing Tee
- Cross
- End Cap
- Coupling
- Reducing Coupling
- Hex Bushing
- Square Head Plug (Cored)
- Square Head Plug (Solid)
- Hex Locknut
- Union

| Project Information | Approval Stamp |
|----------------------|-------------------|
| Project Name: | Approved |
| Project Location: | Approved As Noted |
| Project Contractor: | Not Approved |
| Project Engineer: | Remarks: |
| Project Distributor: | |
| Project Rep: | |
| Submittal Date: | |
| Notes 1: | |
| Notes 2: | |

DIMENSIONAL SPECIFICATIONS

90° Elbow

Lead-Free Import Brass Fittings* 125 LB.

| Part # | Size (IN.) | Approx. Net WT. (LB.) | A | B |
|-----------|------------|-----------------------|------|------|
| XNL101-02 | 1/8 | 0.08 | 0.55 | 0.26 |
| XNL101-04 | 1/4 | 0.10 | 0.72 | 0.35 |
| XNL101-06 | 3/8 | 0.17 | 0.83 | 0.37 |
| XNL101-08 | 1/2 | 0.24 | 1.03 | 0.45 |
| XNL101-12 | 3/4 | 0.40 | 1.19 | 0.52 |
| XNL101-16 | 1 | 0.64 | 1.43 | 0.60 |
| XNL101-20 | 1-1/4 | 0.96 | 1.71 | 0.67 |
| XNL101-24 | 1-1/2 | 1.16 | 1.87 | 0.70 |
| XNL101-32 | 2 | 2.07 | 2.14 | 0.76 |
| XNL101-40 | 2-1/2 | 3.83 | 2.74 | 0.93 |
| XNL101-48 | 3 | 4.62 | 3.10 | 1.00 |
| XNL101-64 | 4 | 7.70 | 3.80 | 1.10 |

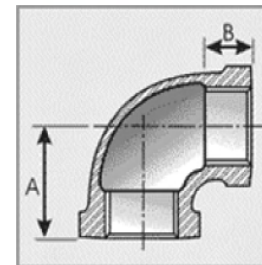

90° Elbow

Lead-Free Import Brass Fittings* 250 LB.

| Part # | Size (IN.) | Approx. Net WT. (LB.) | A | B |
|-----------|------------|-----------------------|------|------|
| XNL150-04 | 1/4 | 0.16 | 0.81 | 0.32 |
| XNL150-06 | 3/8 | 0.26 | 0.95 | 0.36 |
| XNL150-08 | 1/2 | 0.43 | 1.12 | 0.43 |
| XNL150-12 | 3/4 | 0.67 | 1.31 | 0.50 |
| XNL150-16 | 1 | 1.05 | 1.50 | 0.58 |
| XNL150-24 | 1-1/2 | 2.15 | 1.94 | 0.70 |
| XNL150-32 | 2 | 3.52 | 2.25 | 0.75 |

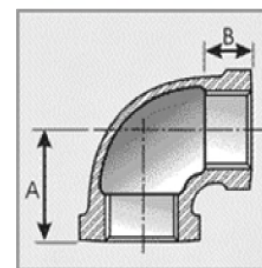

*Conforms with lead content requirements for lead-free plumbing as defined by the U.S. Safe Drinking Water Act. Certified <0.25 weighted average % lead.

DIMENSIONAL SPECIFICATIONS

90° Street Elbow

Lead-Free Import Brass Fittings* 125 LB.

| Part # | Size (IN.) | Approx. Net WT. (LB.) | A | B | C |
|-----------|------------|-----------------------|------|------|------|
| XNL103-02 | 1/8 | 0.07 | 0.55 | 0.92 | 0.28 |
| XNL103-04 | 1/4 | 0.11 | 0.72 | 1.11 | 0.32 |
| XNL103-06 | 3/8 | 0.16 | 0.83 | 1.24 | 0.35 |
| XNL103-08 | 1/2 | 0.24 | 1.03 | 1.51 | 0.45 |
| XNL103-12 | 3/4 | 0.36 | 1.19 | 1.66 | 0.50 |
| XNL103-16 | 1 | 0.62 | 1.43 | 1.98 | 0.58 |
| XNL103-20 | 1-1/4 | 1.03 | 1.71 | 2.26 | 0.67 |
| XNL103-24 | 1-1/2 | 1.27 | 1.87 | 2.46 | 0.75 |
| XNL103-32 | 2 | 2.09 | 2.14 | 2.98 | 0.78 |
| XNL103-40 | 2-1/2 | 4.05 | 2.74 | 3.92 | 0.92 |
| XNL103-48 | 3 | 6.38 | 3.10 | 4.45 | 0.98 |
| XNL103-64 | 4 | 11.44 | 3.80 | 5.63 | 1.08 |

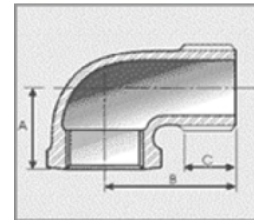

90° Street Elbow

Lead-Free Import Brass Fittings* 250 LB.

| Part # | Size (IN.) | Approx. Net WT. (LB.) | A | B | C |
|-----------|------------|-----------------------|------|------|------|
| XNL160-04 | 1/4 | 0.07 | 0.81 | 1.11 | 0.40 |
| XNL160-12 | 3/4 | 0.56 | 1.31 | 1.69 | 0.55 |
| XNL160-16 | 1 | 0.89 | 1.50 | 1.98 | 0.68 |

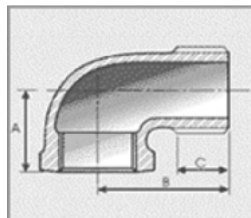

*Conforms with lead content requirements for lead-free plumbing as defined by the U.S. Safe Drinking Water Act. Certified <0.25 weighted average % lead.



DIMENSIONAL SPECIFICATIONS

90° Reducing Elbow

Lead-Free Import Brass Fittings* 125 LB.

| Part # | Size (IN.) | Approx. Net WT. (LB.) | A | B | C |
|-------------|---------------|-----------------------|------|------|------|
| XNL101-0402 | 1/4 x 1/8 | 0.09 | 0.67 | 0.81 | 0.88 |
| XNL101-0604 | 3/8 x 1/4 | 0.15 | 0.81 | 1.00 | 0.92 |
| XNL101-0806 | 1/2 x 3/8 | 0.23 | 0.81 | 1.17 | 1.17 |
| XNL101-1204 | 3/4 x 1/4 | 0.26 | 0.81 | 1.42 | 1.35 |
| XNL101-1206 | 3/4 x 3/8 | 0.30 | 1.00 | 1.42 | 1.35 |
| XNL101-1208 | 3/4 x 1/2 | 0.31 | 1.17 | 1.42 | 1.35 |
| XNL101-1608 | 1 x 1/2 | 0.53 | 1.17 | 1.72 | 1.56 |
| XNL101-1612 | 1 x 3/4 | 0.59 | 1.42 | 1.72 | 1.56 |
| XNL101-2012 | 1-1/4 x 3/4 | 0.73 | 1.42 | 2.10 | 1.77 |
| XNL101-2016 | 1-1/4 x 1 | 0.88 | 1.72 | 2.10 | 1.77 |
| XNL101-2412 | 1-1/2 x 3/4 | 1.00 | 1.72 | 2.10 | 1.77 |
| XNL101-2416 | 1-1/2 x 1 | 0.99 | 1.72 | 2.38 | 1.80 |
| XNL101-2420 | 1-1/2 x 1-1/4 | 1.22 | 2.10 | 2.38 | 1.80 |
| XNL101-3212 | 2 x 3/4 | 1.21 | 2.10 | 2.92 | 2.03 |
| XNL101-3216 | 2 x 1 | 1.30 | 2.10 | 2.92 | 2.03 |
| XNL101-3220 | 2 x 1-1/4 | 1.51 | 2.10 | 2.92 | 2.03 |
| XNL101-3224 | 2 x 1-1/2 | 1.69 | 2.38 | 2.92 | 2.03 |
| XNL101-4032 | 2-1/2 x 2 | 1.21 | 2.92 | 3.49 | 3.15 |
| XNL101-4840 | 3 x 2-1/2 | 4.09 | 3.49 | 4.20 | 3.69 |

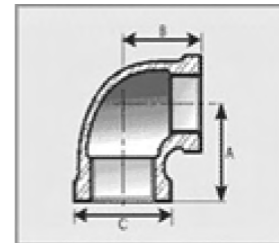

*Conforms with lead content requirements for lead-free plumbing as defined by the U.S. Safe Drinking Water Act. Certified <0.25 weighted average % lead.



DIMENSIONAL SPECIFICATIONS

45° Elbow

Lead-Free Import Brass Fittings* 125 LB.

| Part # | Size (IN.) | Approx. Net WT. (LB.) | A | B |
|-----------|------------|-----------------------|------|------|
| XNL102-02 | 1/8 | 0.08 | 0.43 | 0.43 |
| XNL102-04 | 1/4 | 0.11 | 0.55 | 0.55 |
| XNL102-06 | 3/8 | 0.12 | 0.63 | 0.63 |
| XNL102-08 | 1/2 | 0.25 | 0.79 | 0.79 |
| XNL102-12 | 3/4 | 0.34 | 0.91 | 0.91 |
| XNL102-16 | 1 | 0.54 | 1.07 | 1.07 |
| XNL102-20 | 1-1/4 | 0.90 | 1.23 | 1.23 |
| XNL102-24 | 1-1/2 | 1.03 | 1.31 | 1.31 |
| XNL102-32 | 2 | 1.54 | 1.47 | 1.47 |
| XNL102-40 | 2-1/2 | 3.30 | 1.98 | 1.98 |
| XNL102-48 | 3 | 3.52 | 2.18 | 2.18 |
| XNL102-64 | 4 | 8.01 | 2.62 | 2.62 |

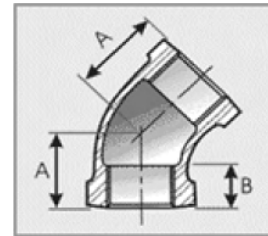

45° Street Elbow

Lead-Free Import Brass Fittings* 125 LB.

| Part # | Size (IN.) | Approx. Net WT. (LB.) | A | B | C | D |
|------------|------------|-----------------------|------|------|------|------|
| XNL103A-02 | 1/8 | 0.06 | 0.26 | 0.43 | 0.28 | 0.79 |
| XNL103A-08 | 1/2 | 0.29 | 0.45 | 0.79 | 0.45 | 1.07 |
| XNL103A-12 | 3/4 | 0.31 | 0.52 | 0.91 | 0.50 | 1.23 |
| XNL103A-16 | 1 | 0.52 | 0.60 | 1.07 | 0.58 | 1.42 |
| XNL103A-20 | 1-1/4 | 0.06 | 0.67 | 1.23 | 0.67 | 1.65 |
| XNL103A-24 | 1-1/4 | 0.97 | 0.70 | 1.31 | 0.75 | 1.83 |
| XNL103A-32 | 2 | 2.04 | 0.76 | 1.47 | 0.78 | 2.14 |

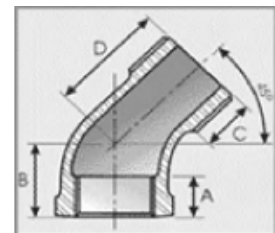

*Conforms with lead content requirements for lead-free plumbing as defined by the U.S. Safe Drinking Water Act. Certified <0.25 weighted average % lead.

DIMENSIONAL SPECIFICATIONS

Tee

Lead-Free Import Brass Fittings* 125 LB.

| Part # | Size (IN.) | Approx. Net WT. (LB.) | A | B | C |
|-----------|------------|-----------------------|------|------|------|
| XNL106-02 | 1/8 | 0.09 | 0.55 | 0.26 | 0.67 |
| XNL106-04 | 1/4 | 0.16 | 0.72 | 0.35 | 0.81 |
| XNL106-06 | 3/8 | 0.25 | 0.83 | 0.37 | 1.00 |
| XNL106-08 | 1/2 | 0.34 | 1.03 | 0.45 | 1.17 |
| XNL106-12 | 3/4 | 0.52 | 1.19 | 0.52 | 1.42 |
| XNL106-16 | 1 | 0.86 | 1.43 | 0.60 | 1.72 |
| XNL106-20 | 1-1/4 | 1.18 | 1.71 | 0.67 | 2.10 |
| XNL106-24 | 1-1/2 | 1.56 | 1.87 | 0.70 | 2.38 |
| XNL106-32 | 2 | 2.62 | 2.14 | 0.76 | 2.92 |
| XNL106-40 | 2-1/2 | 5.28 | 2.74 | 0.93 | 3.49 |
| XNL106-48 | 3 | 5.98 | 3.10 | 1.00 | 4.20 |
| XNL106-64 | 4 | 13.28 | 3.80 | 1.10 | 5.31 |

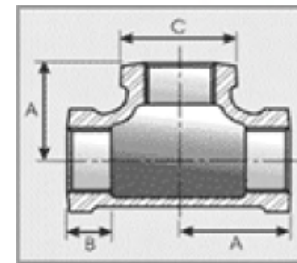

Tee

Lead-Free Import Brass Fittings* 250 LB.

| Part # | Size (IN.) | Approx. Net WT. (LB.) | A | B | C |
|-----------|------------|-----------------------|------|------|------|
| XNL153-04 | 1/4 | 0.12 | 0.81 | 0.38 | 0.93 |
| XNL153-08 | 1/2 | 0.61 | 1.12 | 1.34 | 0.50 |
| XNL153-12 | 3/4 | 0.97 | 1.31 | 1.63 | 0.56 |
| XNL153-16 | 1 | 1.47 | 1.50 | 1.95 | 0.62 |
| XNL153-24 | 1-1/2 | 3.01 | 1.94 | 2.68 | 0.75 |

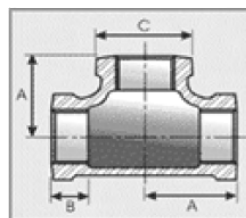

*Conforms with lead content requirements for lead-free plumbing as defined by the U.S. Safe Drinking Water Act. Certified <0.25 weighted average % lead.

DIMENSIONAL SPECIFICATIONS

Reducing Tee

Lead-Free Import Brass Fittings* 125 LB.

| Part # | Size (IN.) | Approx. Net WT. (LB.) | A | B | C |
|---------------|-----------------------|-----------------------|------|------|------|
| XNL106-040402 | 1/4 x 1/4 x 1/8 | 0.11 | 0.65 | 0.65 | 0.60 |
| XNL106-060604 | 3/8 x 3/8 x 1/4 | 0.19 | 0.75 | 0.75 | 0.78 |
| XNL106-080804 | 1/2 x 1/2 x 1/4 | 0.28 | 0.87 | 0.87 | 0.87 |
| XNL106-080806 | 1/2 x 1/2 x 3/8 | 0.29 | 0.93 | 0.93 | 0.90 |
| XNL106-080812 | 1/2 x 1/2 x 3/4 | 0.43 | 1.22 | 1.22 | 1.20 |
| XNL106-120808 | 3/4 x 1/2 x 1/2 | 0.43 | 1.20 | 1.12 | 1.22 |
| XNL106-120812 | 3/4 x 1/2 x 3/4 | 0.49 | 1.37 | 1.31 | 1.45 |
| XNL106-121206 | 3/4 x 3/4 x 3/8 | 0.46 | 1.00 | 1.00 | 1.00 |
| XNL106-121208 | 3/4 x 3/4 x 1/2 | 0.53 | 1.08 | 1.08 | 1.11 |
| XNL106-121216 | 3/4 x 3/4 x 1 | 0.70 | 1.22 | 1.22 | 1.20 |
| XNL106-160808 | 1 x 1/2 x 1/2 | 0.53 | 1.31 | 1.22 | 1.31 |
| XNL106-161208 | 1 x 3/4 x 1/2 | 0.67 | 1.26 | 1.20 | 1.36 |
| XNL106-161212 | 1 x 3/4 x 3/4 | 0.67 | 1.37 | 1.31 | 1.45 |
| XNL106-161604 | 1 x 1 x 1/4 | 0.73 | 1.04 | 1.04 | 1.13 |
| XNL106-161608 | 1 x 1 x 1/2 | 0.73 | 1.20 | 1.20 | 1.24 |
| XNL106-161612 | 1 x 1 x 3/4 | 0.83 | 1.30 | 1.30 | 1.31 |
| XNL106-202012 | 1-1/4 x 1-1/4 x 3/4 | 1.03 | 1.30 | 1.30 | 1.31 |
| XNL106-202016 | 1-1/4 x 1-1/4 x 1 | 1.03 | 1.58 | 1.58 | 1.67 |
| XNL106-242408 | 1-1/2 x 1-1/2 x 1/2 | 1.11 | 1.32 | 1.32 | 1.53 |
| XNL106-242412 | 1-1/2 x 1-1/2 x 3/4 | 1.23 | 1.42 | 1.42 | 1.60 |
| XNL106-242416 | 1-1/2 x 1-1/2 x 1 | 1.31 | 1.55 | 1.55 | 1.72 |
| XNL106-242420 | 1-1/2 x 1-1/2 x 1-1/4 | 1.52 | 1.72 | 1.72 | 1.81 |
| XNL106-323208 | 2 x 2 x 1/2 | 1.65 | 1.49 | 1.49 | 1.88 |
| XNL106-323212 | 2 x 2 x 3/4 | 1.87 | 1.47 | 1.47 | 1.84 |
| XNL106-323216 | 2 x 2 x 1 | 1.91 | 1.60 | 1.60 | 1.98 |
| XNL106-323220 | 2 x 2 x 1-1/4 | 2.20 | 1.77 | 1.77 | 2.04 |
| XNL106-323224 | 2 x 2 x 1-1/2 | 3.08 | 2.02 | 2.02 | 2.16 |

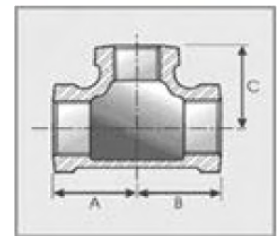

*Conforms with lead content requirements for lead-free plumbing as defined by the U.S. Safe Drinking Water Act. Certified <0.25 weighted average % lead.

DIMENSIONAL SPECIFICATIONS

Cap

Lead-Free Import Brass Fittings* 125 LB.

| Part # | Size (IN.) | Approx. Net WT. (LB.) | G1 | G2 | A |
|-----------|------------|-----------------------|------|------|------|
| XNL116-02 | 1/8 | 0.08 | 0.08 | 0.09 | 0.25 |
| XNL116-04 | 1/4 | 0.07 | 0.08 | 0.10 | 0.32 |
| XNL116-06 | 3/8 | 0.09 | 0.09 | 0.11 | 0.36 |
| XNL116-08 | 1/2 | 0.13 | 0.09 | 0.12 | 0.45 |
| XNL116-12 | 3/4 | 0.22 | 0.10 | 0.13 | 0.50 |
| XNL116-16 | 1 | 0.40 | 0.11 | 0.15 | 0.58 |
| XNL116-20 | 1-1/4 | 0.48 | 0.12 | 0.17 | 0.67 |
| XNL116-24 | 1-1/2 | 0.72 | 0.13 | 0.19 | 0.70 |
| XNL116-32 | 2 | 1.11 | 0.15 | 0.22 | 0.75 |
| XNL116-40 | 2-1/2 | 1.75 | 0.17 | 0.25 | 0.92 |
| XNL116-48 | 3 | 2.71 | 0.19 | 0.29 | 0.98 |
| XNL116-64 | 4 | 4.64 | 0.22 | 0.36 | 1.08 |

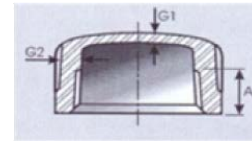

Cap

Lead-Free Import Brass Fittings* 250 LB.

| Part # | Size (IN.) | Approx. Net WT. (LB.) | A | B |
|-----------|------------|-----------------------|------|------|
| XNL158-16 | 1 | 0.54 | 0.58 | 1.10 |

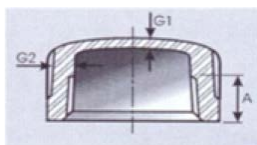

*Conforms with lead content requirements for lead-free plumbing as defined by the U.S. Safe Drinking Water Act. Certified <0.25 weighted average % lead.

DIMENSIONAL SPECIFICATIONS

Coupling

Lead-Free Import Brass Fittings* 125 LB.

| Part # | Size (IN.) | Approx. Net WT. (LB.) | A | B | C |
|-----------|------------|-----------------------|------|------|------|
| XNL111-02 | 1/8 | 0.06 | 0.56 | 0.26 | 0.80 |
| XNL111-04 | 1/4 | 0.08 | 0.69 | 0.26 | 0.80 |
| XNL111-06 | 3/8 | 0.14 | 0.84 | 0.36 | 1.05 |
| XNL111-08 | 1/2 | 0.21 | 1.06 | 0.43 | 1.29 |
| XNL111-12 | 3/4 | 0.30 | 1.31 | 0.50 | 1.43 |
| XNL111-16 | 1 | 0.47 | 1.70 | 0.58 | 1.68 |
| XNL111-20 | 1-1/4 | 0.56 | 2.03 | 0.67 | 1.86 |
| XNL111-24 | 1-1/2 | 1.03 | 2.30 | 0.70 | 1.92 |
| XNL111-32 | 2 | 1.06 | 2.81 | 0.75 | 2.20 |
| XNL111-40 | 2-1/2 | 2.77 | 3.59 | 0.94 | 2.88 |
| XNL111-48 | 3 | 2.75 | 4.16 | 0.98 | 3.18 |
| XNL111-64 | 4 | 6.60 | 5.27 | 1.08 | 3.69 |

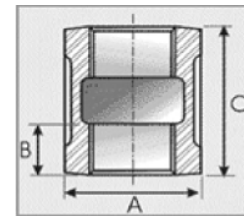

Coupling

Lead-Free Import Brass Fittings* 250 LB.

| Part # | Size (IN.) | Approx. Net WT. (LB.) | A | B |
|-----------|------------|-----------------------|------|------|
| XNL157-04 | 1/4 | 0.13 | 0.32 | 1.06 |
| XNL157-32 | 2 | 2.73 | 0.70 | 2.54 |

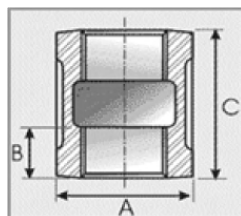

*Conforms with lead content requirements for lead-free plumbing as defined by the U.S. Safe Drinking Water Act. Certified <0.25 weighted average % lead.

DIMENSIONAL SPECIFICATIONS

Reducing Coupling

Lead-Free Import Brass Fittings* 125 LB.

| Part # | Size (IN.) | Approx. Net WT. (LB.) | A | B | C |
|-------------|---------------|-----------------------|------|------|------|
| XNL112-0402 | 1/4 x 1/8 | 0.08 | 0.67 | 0.81 | 0.88 |
| XNL112-0602 | 3/8 x 1/8 | 0.65 | 0.67 | 1.00 | 0.92 |
| XNL112-0604 | 3/8 x 1/4 | 0.12 | 0.81 | 1.00 | 0.92 |
| XNL112-0802 | 1/2 x 1/8 | 0.15 | 0.67 | 1.17 | 1.17 |
| XNL112-0804 | 1/2 x 1/4 | 0.17 | 0.81 | 1.17 | 1.17 |
| XNL112-0806 | 1/2 x 3/8 | 0.17 | 1.00 | 1.17 | 1.17 |
| XNL112-1204 | 3/4 x 1/4 | 0.23 | 0.81 | 1.42 | 1.35 |
| XNL112-1206 | 3/4 x 3/8 | 0.24 | 1.00 | 1.42 | 1.35 |
| XNL112-1208 | 3/4 x 1/2 | 0.26 | 1.17 | 1.42 | 1.35 |
| XNL112-1606 | 1 x 3/8 | 0.41 | 1.00 | 1.72 | 1.56 |
| XNL112-1608 | 1 x 1/2 | 0.39 | 1.17 | 1.72 | 1.56 |
| XNL112-1612 | 1 x 3/4 | 0.45 | 1.42 | 1.72 | 1.56 |
| XNL112-2008 | 1-1/4 x 1/2 | 0.59 | 1.17 | 2.10 | 1.77 |
| XNL112-2012 | 1-1/4 x 3/4 | 0.67 | 1.42 | 2.10 | 1.77 |
| XNL112-2016 | 1-1/4 x 1 | 0.72 | 1.72 | 2.10 | 1.77 |
| XNL112-2408 | 1-1/2 x 1/2 | 0.85 | 1.17 | 2.38 | 1.80 |
| XNL112-2412 | 1-1/2 x 3/4 | 0.92 | 1.42 | 2.38 | 1.80 |
| XNL112-2416 | 1-1/2 x 1 | 0.90 | 1.72 | 2.38 | 1.80 |
| XNL112-2420 | 1-1/2 x 1-1/4 | 0.99 | 2.10 | 2.38 | 1.80 |
| XNL112-3208 | 2 x 1/2 | 1.28 | 1.17 | 2.92 | 2.03 |
| XNL112-3212 | 2 x 3/4 | 1.25 | 1.42 | 2.92 | 2.03 |
| XNL112-3216 | 2 x 1 | 1.39 | 1.72 | 2.92 | 2.03 |
| XNL112-3220 | 2 x 1-1/4 | 1.05 | 2.10 | 2.92 | 2.03 |
| XNL112-3224 | 2 x 1-1/2 | 1.74 | 2.38 | 2.92 | 2.03 |
| XNL112-4020 | 2-1/2 x 1-1/4 | 2.08 | 2.10 | 3.49 | 3.25 |
| XNL112-4024 | 2-1/2 x 1-1/2 | 1.94 | 2.38 | 3.49 | 3.25 |
| XNL112-4032 | 2-1/2 x 2 | 2.11 | 2.92 | 3.49 | 3.25 |
| XNL112-4824 | 3 x 1-1/2 | 2.35 | 2.92 | 4.20 | 3.69 |
| XNL112-4832 | 3 x 2 | 2.40 | 2.92 | 4.20 | 3.69 |
| XNL112-4840 | 3 x 2-1/2 | 2.40 | 3.49 | 4.20 | 3.69 |
| XNL112-6448 | 4 x 3 | 4.58 | 4.20 | 5.31 | 4.38 |

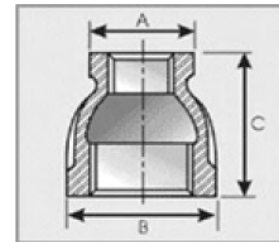

*Conforms with lead content requirements for lead-free plumbing as defined by the U.S. Safe Drinking Water Act. Certified <0.25 weighted average % lead.



DIMENSIONAL SPECIFICATIONS

Cross

Lead-Free Import Brass Fittings* 125 LB.

| Part # | Size (IN.) | Approx. Net WT. (LB.) | A | B | C |
|-----------|------------|-----------------------|------|------|------|
| XNL110-04 | 1/4 | 0.20 | 0.72 | 0.34 | 0.81 |
| XNL110-08 | 1/2 | 0.44 | 1.03 | 0.45 | 1.17 |
| XNL110-12 | 3/4 | 0.68 | 1.19 | 0.52 | 1.42 |
| XNL110-16 | 1 | 1.08 | 1.43 | 0.60 | 1.72 |
| XNL110-24 | 1-1/2 | 1.97 | 1.87 | 0.70 | 2.38 |
| XNL110-32 | 2 | 2.52 | 2.14 | 0.76 | 2.92 |

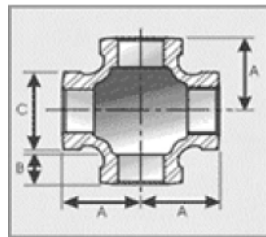

Hex Locknut

Lead-Free Import Brass Fittings* 125 LB.

| Part # | Size (IN.) | Approx. Net WT. (LB.) | A | B | C |
|-----------|------------|-----------------------|------|------|------|
| XNL119-02 | 1/8 | 0.03 | 0.19 | 0.50 | 0.04 |
| XNL119-04 | 1/4 | 0.03 | 0.25 | 0.66 | 0.06 |
| XNL119-06 | 3/8 | 0.04 | 0.28 | 0.77 | 0.06 |
| XNL119-08 | 1/2 | 0.10 | 0.31 | 0.97 | 0.06 |
| XNL119-12 | 3/4 | 0.13 | 0.34 | 1.23 | 0.06 |
| XNL119-16 | 1 | 0.20 | 0.38 | 1.50 | 0.06 |
| XNL119-20 | 1-1/4 | 0.29 | 0.42 | 1.86 | 0.06 |
| XNL119-24 | 1-1/2 | 0.52 | 0.47 | 2.12 | 0.06 |
| XNL119-32 | 2 | 0.64 | 0.53 | 2.63 | 0.09 |

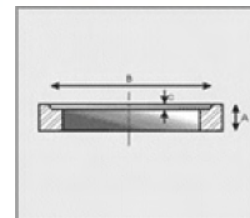

*Conforms with lead content requirements for lead-free plumbing as defined by the U.S. Safe Drinking Water Act. Certified <0.25 weighted average % lead.

DIMENSIONAL SPECIFICATIONS

Hex Bushing

Lead-Free Import Brass Fittings* 125 LB.

| Part # | Size (IN.) | Approx. Net WT. (LB.) | A | B | C |
|-------------|---------------|-----------------------|------|------|------|
| XNL114-0802 | 1/2 x 1/8 | 0.10 | 0.56 | 0.25 | 0.19 |
| XNL114-0804 | 1/2 x 1/4 | 0.09 | 0.56 | 0.32 | 0.19 |
| XNL114-0806 | 1/2 x 3/8 | 0.07 | 0.56 | 0.41 | 0.19 |
| XNL114-1202 | 3/4 x 1/8 | 0.17 | 0.63 | 0.38 | 0.25 |
| XNL114-1204 | 3/4 x 1/4 | 0.17 | 0.63 | 0.32 | 0.22 |
| XNL114-1206 | 3/4 x 3/8 | 0.16 | 0.63 | 0.36 | 0.22 |
| XNL114-1208 | 3/4 x 1/2 | 0.11 | 0.63 | 0.53 | 0.22 |
| XNL114-1604 | 1 x 1/4 | 0.24 | 0.75 | 0.32 | 0.30 |
| XNL114-1606 | 1 x 3/8 | 0.22 | 0.75 | 0.36 | 0.30 |
| XNL114-1608 | 1 x 1/2 | 0.21 | 0.75 | 0.43 | 0.25 |
| XNL114-1612 | 1 x 3/4 | 0.24 | 0.75 | 0.50 | 0.25 |
| XNL114-2004 | 1-1/4 x 1/4 | 0.34 | 0.80 | 0.32 | 0.34 |
| XNL114-2006 | 1-1/4 x 3/8 | 0.40 | 0.81 | 0.38 | 0.34 |
| XNL114-2008 | 1-1/4 x 1/2 | 0.47 | 0.80 | 0.43 | 0.34 |
| XNL114-2012 | 1-1/4 x 3/4 | 0.41 | 0.80 | 0.50 | 0.28 |
| XNL114-2016 | 1-1/4 x 1 | 0.39 | 0.80 | 0.58 | 0.28 |
| XNL114-2404 | 1-1/2 x 1/4 | 0.43 | 0.81 | 0.32 | 0.34 |
| XNL114-2406 | 1-1/2 x 3/8 | 0.45 | 0.81 | 0.36 | 0.34 |
| XNL114-2408 | 1-1/2 x 1/2 | 0.72 | 0.83 | 0.43 | 0.37 |
| XNL114-2412 | 1-1/2 x 3/4 | 0.50 | 0.83 | 0.50 | 0.37 |
| XNL114-2416 | 1-1/2 x 1 | 0.49 | 0.83 | 0.58 | 0.31 |
| XNL114-2420 | 1-1/2 x 1-1/4 | 0.43 | 0.83 | 0.71 | 0.31 |
| XNL114-3208 | 2 x 1/2 | 1.10 | 0.88 | 0.43 | 0.43 |
| XNL114-3212 | 2 x 3/4 | 1.15 | 0.88 | 0.50 | 0.43 |
| XNL114-3216 | 2 x 1 | 1.02 | 0.88 | 0.58 | 0.41 |
| XNL114-3220 | 2 x 1-1/4 | 0.87 | 0.88 | 0.67 | 0.34 |
| XNL114-3224 | 2 x 1-1/2 | 0.81 | 0.88 | 0.70 | 0.34 |
| XNL114-4016 | 2-1/2 x 1 | 1.76 | 1.09 | 0.59 | 0.44 |
| XNL114-4020 | 2-1/2 x 1-1/4 | 1.67 | 1.09 | 0.69 | 0.44 |
| XNL114-4024 | 2-1/2 x 1-1/2 | 1.15 | 1.09 | 0.72 | 0.44 |
| XNL114-4032 | 2-1/2 x 2 | 5.98 | 1.07 | 0.75 | 0.37 |
| XNL114-4824 | 3 x 1-1/2 | 2.44 | 1.13 | 0.72 | 0.50 |
| XNL114-4832 | 3 x 2 | 1.70 | 1.13 | 0.75 | 0.48 |
| XNL114-4840 | 3 x 2-1/2 | 1.69 | 1.13 | 0.92 | 0.40 |
| XNL114-6432 | 4 x 2 | 3.16 | 1.22 | 0.75 | 0.60 |
| XNL114-6448 | 4 x 3 | 3.74 | 1.22 | 0.98 | 0.50 |

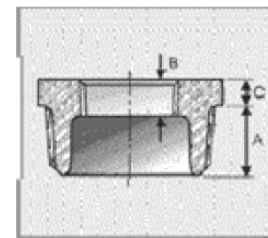

*Conforms with lead content requirements for lead-free plumbing as defined by the U.S. Safe Drinking Water Act. Certified <0.25 weighted average % lead.



DIMENSIONAL SPECIFICATIONS

Square Head Cored Plug

Lead-Free Import Brass Fittings* 125 LB.

| Part # | Size (IN.) | Approx. Net WT. (LB.) | A | B | C |
|-----------|------------|-----------------------|------|------|------|
| XNL117-08 | 1/2 | 0.11 | 0.54 | 0.56 | 0.38 |
| XNL117-12 | 3/4 | 0.16 | 0.55 | 0.63 | 0.44 |
| XNL117-16 | 1 | 0.25 | 0.69 | 0.81 | 0.50 |
| XNL117-20 | 1-1/4 | 0.38 | 0.71 | 0.94 | 0.56 |
| XNL117-24 | 1-1/2 | 0.52 | 0.73 | 1.13 | 0.62 |
| XNL117-32 | 2 | 0.83 | 0.76 | 1.31 | 0.68 |
| XNL117-40 | 2-1/2 | 1.26 | 1.07 | 1.50 | 0.74 |
| XNL117-48 | 3 | 1.49 | 1.13 | 1.69 | 0.80 |
| XNL117-64 | 4 | 3.20 | 1.22 | 2.25 | 0.92 |

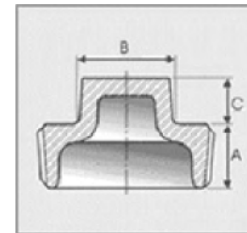

Square Head Solid Plug

Lead-Free Import Brass Fittings* 125 LB.

| Part # | Size (IN.) | Approx. Net WT. (LB.) | A | B | C |
|------------|------------|-----------------------|------|------|------|
| XNL117A-06 | 3/8 | 0.07 | 0.41 | 0.44 | 0.31 |
| XNL117A-08 | 1/2 | 0.12 | 0.54 | 0.56 | 0.38 |
| XNL117A-12 | 3/4 | 0.18 | 0.55 | 0.63 | 0.44 |
| XNL117A-16 | 1 | 0.38 | 0.69 | 0.81 | 0.50 |
| XNL117A-20 | 1-1/4 | 0.59 | 0.71 | 0.94 | 0.56 |
| XNL117A-24 | 1-1/2 | 0.89 | 0.73 | 1.13 | 0.62 |
| XNL117A-32 | 2 | 1.39 | 0.76 | 1.31 | 0.68 |
| XNL117A-40 | 2-1/2 | 2.35 | 1.07 | 1.50 | 0.74 |
| XNL117A-48 | 3 | 3.59 | 1.13 | 1.69 | 0.80 |
| XNL117A-64 | 4 | 6.82 | 1.22 | 2.25 | 0.92 |

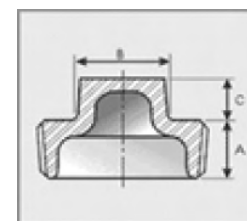
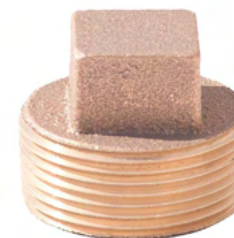

*Conforms with lead content requirements for lead-free plumbing as defined by the U.S. Safe Drinking Water Act. Certified <0.25 weighted average % lead.



DIMENSIONAL SPECIFICATIONS

Union

Lead-Free Import Brass Fittings* 125 LB.

| Part # | Size (IN.) | Approx. Net WT. (LB.) | A |
|-----------|------------|-----------------------|------|
| XNL187-02 | 1/8 | 0.13 | 1.17 |
| XNL187-04 | 1/4 | 0.22 | 1.25 |
| XNL187-06 | 3/8 | 0.39 | 1.48 |
| XNL187-08 | 1/2 | 0.47 | 1.56 |
| XNL187-12 | 3/4 | 0.69 | 1.87 |
| XNL187-16 | 1 | 1.03 | 2.11 |
| XNL187-20 | 1-1/4 | 1.52 | 2.34 |
| XNL187-24 | 1-1/2 | 2.09 | 2.65 |
| XNL187-32 | 2 | 3.12 | 2.96 |
| XNL187-40 | 2-1/2 | 5.39 | 3.32 |
| XNL187-48 | 3 | 6.49 | 3.71 |
| XNL187-64 | 4 | 5.20 | 4.60 |

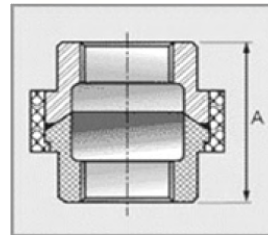

Union

Lead-Free Import Brass Fittings* 250 LB.

| Part # | Size (IN.) | Approx. Net WT. (LB.) | A |
|-----------|------------|-----------------------|------|
| XNL190-04 | 1/4 | 0.16 | 1.56 |
| XNL190-08 | 1/2 | 0.62 | 2.00 |
| XNL190-12 | 3/4 | 1.06 | 2.13 |
| XNL190-16 | 1 | 1.40 | 2.44 |
| XNL190-24 | 1-1/2 | 2.94 | 2.81 |
| XNL190-32 | 2 | 3.42 | 3.19 |

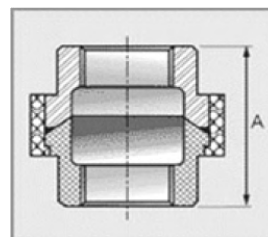

*Conforms with lead content requirements for lead-free plumbing as defined by the U.S. Safe Drinking Water Act. Certified <0.25 weighted average % lead.



LOCATIONS

SPARKS DISTRIBUTION CENTER
200 Vista Boulevard Suite #106
Sparks, NV 89434

LONG BEACH PIPE DEPOT
2396 E. Artesia Blvd
Long Beach, CA 90805

DALLAS DISTRIBUTION CENTER
10614 King William Drive
Dallas, TX 75220

CLEVELAND HEADQUARTERS
One Merit Drive/PO Box 43127
Cleveland, OH 44143

BIRMINGHAM DISTRIBUTION CENTER
220 Oxmoor Court
Birmingham, AL 35209

HOUSTON DISTRIBUTION CENTER
4680 S. Sam Houston Pkwy W, Suite 120
Houston, TX 77053

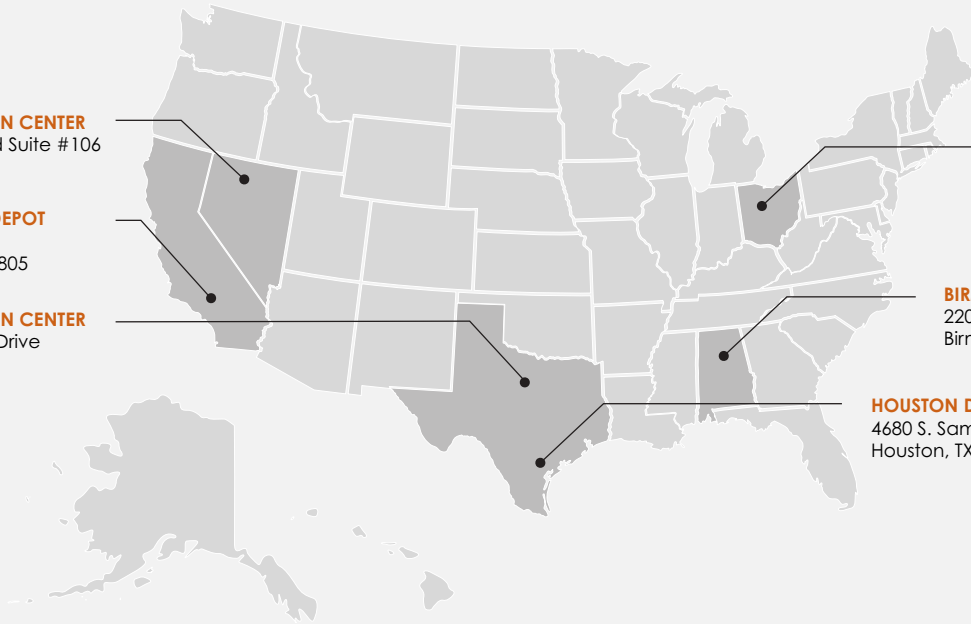

SHIPPING TIMES

UPS

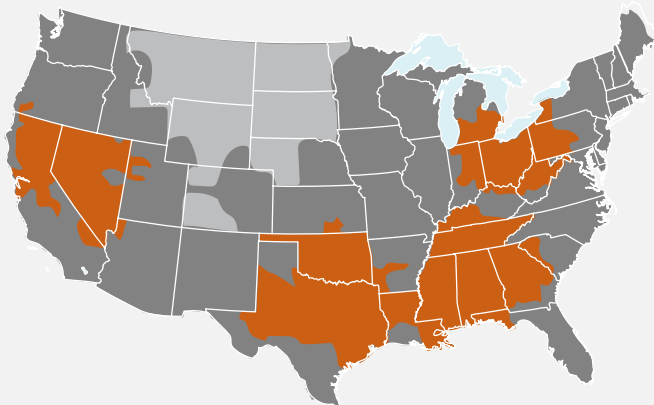

1 Day 2 Days 3 Days

FedEx

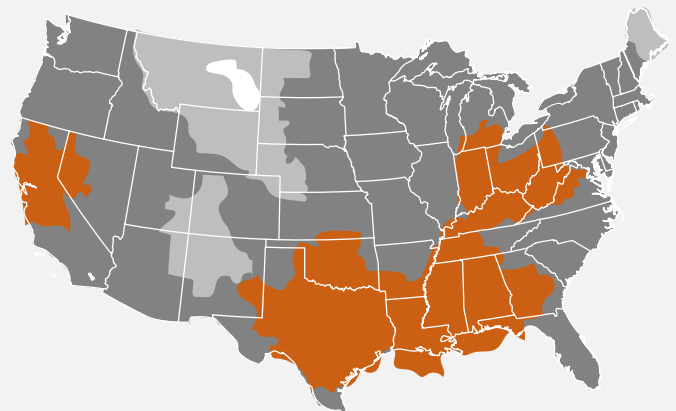

1 Day 2 Days 3 Days 4 Days

*FedEx is Merit's Primary Carrier

LEARN MORE



800.726.9800

Follow us on      

www.meritbrass.com
www.mbwebxpress.com
contactus@meritbrass.com

Merit Brass Headquarters Has An ISO 9001:2015 Registered Quality Management System