



DIRECTING THE FLOW OF *Quality*

WWW.MERITBRASS.COM
www.mbwebxpress.com

Merit Brass Co.
One Merit Dr. • PO Box 43127
Cleveland, OH 44143

2
0
2
4

DIMENSIONAL CATALOG

Leaded Import Brass Fittings



DIMENSIONAL SPECIFICATIONS

90° Elbow

Leaded Import Brass Fittings** 125 LB.

Part #	Size (IN.)	Approx. Net WT. (LB.)	A	B
X101-02	1/8	0.07	0.54	0.54
X101-04	1/4	0.13	0.71	0.71
X101-06	3/8	0.17	0.82	0.82
X101-08	1/2	0.22	1.01	1.01
X101-12	3/4	0.37	1.18	1.18
X101-16	1	0.52	1.43	1.43
X101-20	1-1/4	0.96	1.69	1.69
X101-24	1-1/2	1.16	1.84	1.84
X101-32	2	2.07	2.12	2.12
X101-40	2-1/2	3.83	2.70	2.70
X101-48	3	4.62	3.08	3.08
X101-64	4	7.70	3.79	3.79

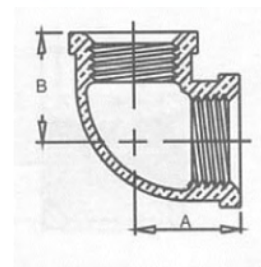

90° Elbow

Leaded Import Brass Fittings** 250 LB.

Part #	Size (IN.)	Approx. Net WT. (LB.)	A	B
X150-04	1/4	0.16	0.81	0.32
X150-06	3/8	0.26	0.95	0.36
X150-08	1/2	0.43	1.12	0.43
X150-12	3/4	0.67	1.31	0.50
X150-16	1	1.05	1.50	0.58
X150-20	1-1/4	1.68	1.75	0.67
X150-24	1-1/2	2.15	1.94	0.70
X150-32	2	3.52	2.25	0.75
X150-40	2-1/2	5.43	2.70	0.92
X150-48	3	7.99	3.08	1.08

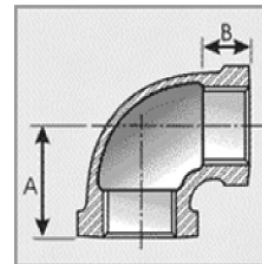

**  **WARNING:** This product can expose you to Lead, which is known to the State of California to cause cancer and birth defects or other reproductive harm. For more information go to www.P65Warnings.ca.gov. This product is not for use in potable water.

DIMENSIONAL SPECIFICATIONS

90° Street Elbow

Leaded Import Brass Fittings** 125 LB.

Part #	Size (IN.)	Approx. Net WT. (LB.)	A	B
X103-02	1/8	0.06	0.55	0.92
X103-04	1/4	0.11	0.72	1.11
X103-06	3/8	0.17	0.83	1.24
X103-08	1/2	0.21	1.03	1.51
X103-12	3/4	0.31	1.19	1.66
X103-16	1	0.63	1.43	1.98
X103-20	1-1/4	1.03	1.71	2.26
X103-24	1-1/2	1.27	1.87	2.46
X103-32	2	2.09	2.14	2.98
X103-40	2-1/2	4.05	2.74	3.92
X103-48	3	6.38	3.10	4.45

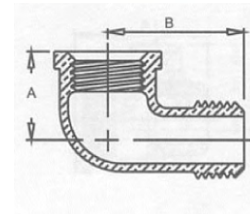

90° Street Elbow

Leaded Import Brass Fittings** 250 LB.

Part #	Size (IN.)	Approx. Net WT. (LB.)	A	B	C
X160-04	1/4	0.20	0.81	1.11	0.40
X160-06	3/8	0.20	0.94	1.24	0.40
X160-08	1/2	0.33	1.22	1.49	0.53
X160-12	3/4	0.56	1.31	1.69	0.55
X160-16	1	0.89	1.50	1.98	0.68
X160-20	1-1/4	1.45	1.75	2.24	0.74
X160-24	1-1/2	1.95	1.94	2.48	0.75
X160-32	2	3.01	2.25	2.88	0.75

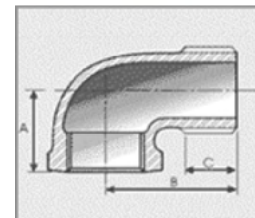

**  **WARNING:** This product can expose you to Lead, which is known to the State of California to cause cancer and birth defects or other reproductive harm. For more information go to www.P65Warnings.ca.gov. This product is not for use in potable water.

DIMENSIONAL SPECIFICATIONS

90° Reducing Elbow

Leaded Import Brass Fittings** 125 LB.

Part #	Size (IN.)	Approx. Net WT. (LB.)	A	B
X101-0402	1/4 x 1/8	0.10	0.65	0.60
X101-0604	3/8 x 1/4	0.15	0.75	0.75
X101-0804	1/2 x 1/4	0.19	1.78	1.69
X101-0806	1/2 x 3/8	0.23	0.93	0.90
X101-1204	3/4 x 1/4	0.26	1.00	1.00
X101-1206	3/4 x 3/8	0.30	0.97	0.97
X101-1208	3/4 x 1/2	0.31	1.08	1.11
X101-1608	1 x 1/2	0.53	1.20	1.24
X101-1612	1 x 3/4	0.59	1.30	1.31
X101-2008	1-1/4 x 1/2	0.61	1.25	1.38
X101-2016	1-1/4 x 1	0.81	1.52	1.60
X101-2412	1-1/2 x 3/4	0.83	1.50	1.75
X101-2416	1-1/2 x 1	0.98	1.55	1.72
X101-2420	1-1/2 x 1-1/4	1.22	1.72	1.81
X101-3208	2 x 1/2	1.10	1.17	2.92
X101-3216	2 x 1	1.30	1.56	1.94
X101-3220	2 x 1-1/4	1.51	1.75	2.06
X101-3224	2 x 1-1/2	1.69	1.89	2.07
X101-4032	2-1/2 x 2	2.99	2.39	2.60
X101-4832	3 x 2	3.63	2.50	2.88
X101-4840	3 x 2-1/2	4.09	2.83	2.99

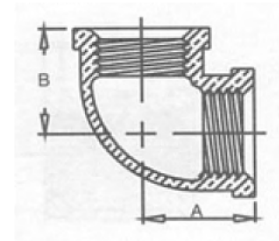

**  **WARNING:** This product can expose you to Lead, which is known to the State of California to cause cancer and birth defects or other reproductive harm. For more information go to www.P65Warnings.ca.gov. This product is not for use in potable water.

DIMENSIONAL SPECIFICATIONS

45° Elbow

Leaded Import Brass Fittings** 125 LB.

Part #	Size (IN.)	Approx. Net WT. (LB.)	A	B
X102-02	1/8	0.07	0.43	0.43
X102-04	1/4	0.11	0.55	0.55
X102-06	3/8	0.12	0.63	0.63
X102-08	1/2	0.25	0.79	0.79
X102-12	3/4	0.34	0.91	0.91
X102-16	1	0.54	1.07	1.07
X102-20	1-1/4	0.90	1.23	1.23
X102-24	1-1/2	1.03	1.31	1.31
X102-32	2	1.54	1.47	1.47
X102-40	2-1/2	3.30	1.89	1.89
X102-48	3	3.52	2.18	2.18

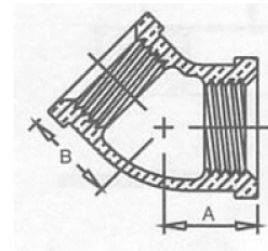

45° Elbow

Leaded Import Brass Fittings** 250 LB.

Part #	Size (IN.)	Approx. Net WT. (LB.)	A	B
X152-08	1/2	0.39	1.12	0.43
X152-12	3/4	0.62	1.31	0.50
X152-16	1	0.91	1.50	0.58
X152-20	1-1/4	1.45	1.75	0.67
X152-24	1-1/2	1.96	1.94	0.70
X152-32	2	3.14	2.25	0.75

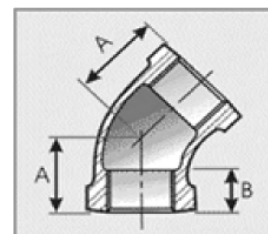

**  **WARNING:** This product can expose you to Lead, which is known to the State of California to cause cancer and birth defects or other reproductive harm. For more information go to www.P65Warnings.ca.gov. This product is not for use in potable water.

DIMENSIONAL SPECIFICATIONS

45° Street Elbow

Leaded Import Brass Fittings** 125 LB.

Part #	Size (IN.)	Approx. Net WT. (LB.)	A	B
X103A-04	1/4	0.09	0.56	0.88
X103A-06	3/8	0.14	0.63	0.92
X103A-08	1/2	0.29	0.78	1.06
X103A-12	3/4	0.31	0.89	1.23
X103A-16	1	0.52	1.06	1.40
X103A-20	1-1/4	0.77	1.22	1.64
X103A-24	1-1/2	0.97	1.30	1.80
X103A-32	2	2.04	1.45	2.14

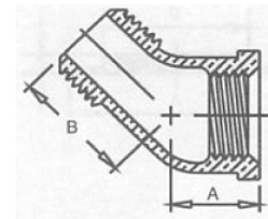

Tee

Leaded Import Brass Fittings** 125 LB.

Part #	Size (IN.)	Approx. Net WT. (LB.)	A	B	C
X106-02	1/8	0.09	0.54	0.54	0.54
X106-04	1/4	0.16	0.71	0.71	0.71
X106-06	3/8	0.24	0.82	0.82	0.82
X106-08	1/2	0.29	1.01	1.01	1.01
X106-12	3/4	0.44	1.18	1.18	1.18
X106-16	1	0.77	1.43	1.43	1.43
X106-20	1-1/4	1.18	1.69	1.69	1.69
X106-24	1-1/2	1.56	1.84	1.84	1.84
X106-32	2	2.62	2.12	2.12	2.12
X106-40	2-1/2	5.28	2.70	2.70	2.70
X106-48	3	5.98	3.08	3.08	3.08
X106-64	4	10.78	3.79	3.79	3.79

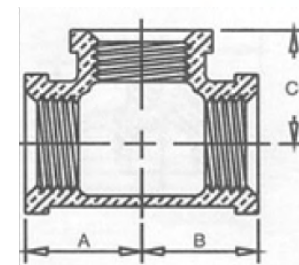

**  **WARNING:** This product can expose you to Lead, which is known to the State of California to cause cancer and birth defects or other reproductive harm. For more information go to www.P65Warnings.ca.gov. This product is not for use in potable water.

DIMENSIONAL SPECIFICATIONS

Tee

Leaded Import Brass Fittings** 250 LB.

Part #	Size (IN.)	Approx. Net WT. (LB.)	A	B	C
X153-04	1/4	0.24	0.81	0.93	0.38
X153-06	3/8	0.37	0.95	1.12	0.44
X153-08	1/2	0.61	1.12	1.34	0.50
X153-12	3/4	0.97	1.31	1.63	0.56
X153-16	1	1.47	1.50	1.95	0.62
X153-20	1-1/4	2.23	1.75	2.39	0.69
X153-24	1-1/2	3.01	1.94	2.68	0.75
X153-32	2	4.79	2.25	3.28	0.84
X153-40	2-1/2	7.19	2.70	3.86	0.94
X153-48	3	10.84	3.08	4.62	1.00

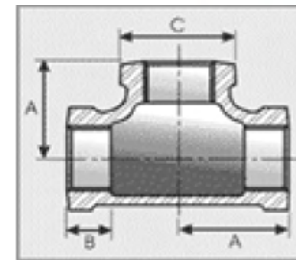

Reducing Tee

Leaded Import Brass Fittings** 125 LB.

Part #	Size (IN.)	Approx. Net WT. (LB.)	A	B	C
X106-040402	1/4 x 1/4 x 1/8	0.14	0.65	0.65	0.60
X106-060604	3/8 x 3/8 x 1/4	0.21	0.75	0.75	0.78
X106-080408	1/2 x 1/4 x 1/2	0.28	0.93	0.87	0.93
X106-080806	1/2 x 1/2 x 3/8	0.32	0.93	0.93	0.90
X106-080812	1/2 x 1/2 x 3/4	0.47	1.11	1.11	1.08
X106-120808	3/4 x 1/2 x 1/2	0.43	1.08	1.01	1.11
X106-120812	3/4 x 1/2 x 3/4	0.49	1.18	1.11	1.18
X106-121204	3/4 x 3/4 x 1/4	0.38	1.00	1.00	1.00
X106-121206	3/4 x 3/4 x 3/8	0.46	1.00	1.00	1.00
X106-121208	3/4 x 3/4 x 1/2	0.53	1.08	1.08	1.11
X106-121216	3/4 x 3/4 x 1	0.73	1.31	1.31	1.30
X106-160808	1 x 1/2 x 1/2	0.43	1.31	1.22	1.31

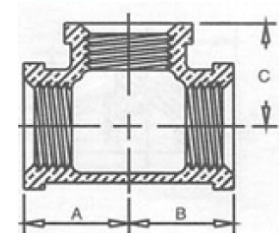

**  **WARNING:** This product can expose you to Lead, which is known to the State of California to cause cancer and birth defects or other reproductive harm. For more information go to www.P65Warnings.ca.gov. This product is not for use in potable water.

DIMENSIONAL SPECIFICATIONS

Reducing Tee (Continued)

Leaded Import Brass Fittings** 125 LB.

Part #	Size (IN.)	Approx. Net WT. (LB.)	A	B	C
X106-160812	1 x 1/2 x 3/4	0.49	1.30	1.11	1.31
X106-160816	1 x 1/2 x 1	0.73	1.43	1.24	1.43
X106-161208	1 x 3/4 x 1/2	0.67	1.20	1.08	1.24
X106-161212	1 x 3/4 x 3/4	0.70	1.30	1.08	1.31
X106-161606	1 x 1 x 3/8	0.63	1.12	1.12	1.13
X106-161608	1 x 1 x 1/2	0.73	1.20	1.20	1.24
X106-161612	1 x 1 x 3/4	0.83	1.30	1.30	1.31
X106-161620	1 x 1 x 1-1/4	0.97	1.60	1.60	1.52
X106-200820	1-1/4 x 1/2 x 1-1/4	1.05	1.69	1.40	1.69
X106-202008	1-1/4 x 1-1/4 x 1/2	1.05	1.29	1.29	1.41
X106-202012	1-1/4 x 1-1/4 x 3/4	1.04	1.39	1.39	1.48
X106-202016	1-1/4 x 1-1/4 x 1	1.12	1.52	1.52	1.60
X106-240824	1-1/2 x 1/2 x 1-1/2	1.11	1.81	1.56	1.81
X106-242408	1-1/2 x 1-1/2 x 1/2	1.11	1.32	1.32	1.53
X106-242412	1-1/2 x 1-1/2 x 3/4	1.23	1.42	1.42	1.60
X106-242416	1-1/2 x 1-1/2 x 1	1.31	1.55	1.55	1.72
X106-242420	1-1/2 x 1-1/2 x 1-1/4	1.52	1.72	1.72	1.81
X106-323208	2 x 2 x 1/2	1.65	1.50	1.50	1.88
X106-323212	2 x 2 x 3/4	1.87	1.47	1.47	1.84
X106-323216	2 x 2 x 1	1.91	1.59	1.59	1.95
X106-323220	2 x 2 x 1-1/4	2.15	1.77	1.77	2.04
X106-323224	2 x 2 x 1-1/2	3.08	1.89	1.89	2.07
X106-404016	2-1/2 x 2-1/2 x 1	4.07	1.88	1.88	2.38
X106-404032	2-1/2 x 2-1/2 x 2	4.07	2.39	2.39	2.60
X106-484832	3 x 3 x 2	4.36	2.52	2.52	2.89
X106-484840	3 x 3 x 2-1/2	5.50	2.83	2.83	2.99
X106-646432	4 x 4 x 2	7.59	2.75	2.75	3.41

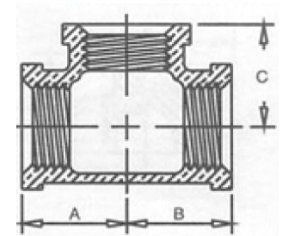

**  **WARNING:** This product can expose you to Lead, which is known to the State of California to cause cancer and birth defects or other reproductive harm. For more information go to www.P65Warnings.ca.gov. This product is not for use in potable water.

DIMENSIONAL SPECIFICATIONS

Cross

Leaded Import Brass Fittings** 125 LB.

Part #	Size (IN.)	Approx. Net WT. (LB.)	A	B
X110-02	1/8	0.13	0.54	0.54
X110-04	1/4	0.20	0.71	0.71
X110-06	3/8	0.29	0.82	0.82
X110-08	1/2	0.43	1.01	1.01
X110-12	3/4	0.68	1.18	1.18
X110-16	1	1.08	1.43	1.43
X110-20	1-1/4	1.70	1.69	1.69
X110-24	1-1/2	1.97	1.84	1.84
X110-32	2	2.52	2.12	2.12
X110-40	2-1/2	5.73	2.70	2.70

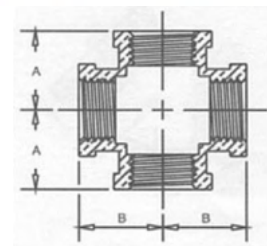

Cross

Leaded Import Brass Fittings** 250 LB.

Part #	Size (IN.)	Approx. Net WT. (LB.)	A	B
X154-04	1/4	0.32	0.81	0.93
X154-06	3/8	0.4	0.95	1.12
X154-08	1/2	0.75	1.12	1.34
X154-12	3/4	1.25	1.31	1.63
X154-16	1	1.9	1.50	1.95
X154-20	1-1/4	2.85	1.75	2.39
X154-24	1-1/2	3.85	1.94	2.68
X154-32	2	5.9	2.25	3.28

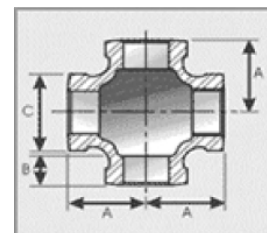

**  **WARNING:** This product can expose you to Lead, which is known to the State of California to cause cancer and birth defects or other reproductive harm. For more information go to www.P65Warnings.ca.gov. This product is not for use in potable water.

DIMENSIONAL SPECIFICATIONS

Cap

Leaded Import Brass Fittings** 125 LB.

Part #	Size (IN.)	Approx. Net WT. (LB.)	A
X116-02	1/8	0.04	0.49
X116-04	1/4	0.07	0.59
X116-06	3/8	0.09	0.66
X116-08	1/2	0.13	0.78
X116-12	3/4	0.22	0.84
X116-16	1	0.40	1.00
X116-20	1-1/4	0.48	1.13
X116-24	1-1/2	0.72	1.16
X116-32	2	1.11	1.34
X116-40	2-1/2	1.75	1.72
X116-48	3	2.71	1.81
X116-64	4	3.76	2.09

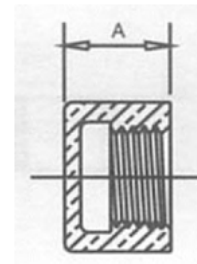

Cap

Leaded Import Brass Fittings** 250 LB.

Part #	Size (IN.)	Approx. Net WT. (LB.)	A	B
X158-04	1/4	0.09	0.32	0.67
X158-06	3/8	0.15	0.36	0.76
X158-08	1/2	0.22	0.44	0.86
X158-12	3/4	0.37	0.51	1.02
X158-16	1	0.54	0.58	1.10
X158-20	1-1/4	0.87	0.68	1.29
X158-24	1-1/2	1.12	0.70	1.33
X158-32	2	1.80	0.75	1.55
X158-40	2-1/2	4.19	0.92	1.81

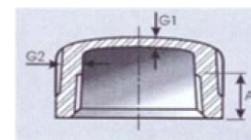

**  **WARNING:** This product can expose you to Lead, which is known to the State of California to cause cancer and birth defects or other reproductive harm. For more information go to www.P65Warnings.ca.gov. This product is not for use in potable water.

DIMENSIONAL SPECIFICATIONS

Coupling

Leaded Import Brass Fittings** 125 LB.

Part #	Size (IN.)	Approx. Net WT. (LB.)	A
X111-02	1/8	0.06	0.80
X111-04	1/4	0.10	0.80
X111-06	3/8	0.14	1.05
X111-08	1/2	0.19	1.29
X111-12	3/4	0.29	1.43
X111-16	1	0.45	1.68
X111-20	1-1/4	0.56	1.86
X111-24	1-1/2	1.03	1.92
X111-32	2	1.06	2.20
X111-40	2-1/2	2.77	2.88
X111-48	3	2.75	3.18

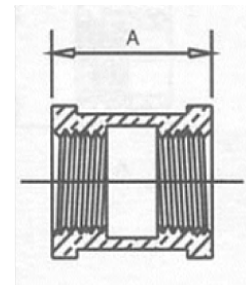

Coupling

Leaded Import Brass Fittings** 250 LB.

Part #	Size (IN.)	Approx. Net WT. (LB.)	A	B
X157-04	1/4	0.14	0.32	1.06
X157-06	3/8	0.22	0.36	1.16
X157-08	1/2	0.33	0.44	1.35
X157-12	3/4	0.54	0.51	1.53
X157-16	1	0.79	0.58	1.68
X157-20	1-1/4	1.26	0.68	1.95
X157-24	1-1/2	1.71	0.70	2.15
X157-32	2	2.73	0.70	2.54
X157-40	2-1/2	4.11	0.92	2.90
X157-48	3	5.98	1.00	3.20

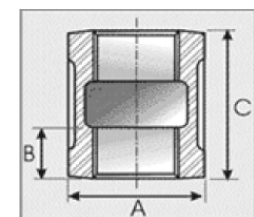

**  **WARNING:** This product can expose you to Lead, which is known to the State of California to cause cancer and birth defects or other reproductive harm. For more information go to www.P65Warnings.ca.gov. This product is not for use in potable water.

DIMENSIONAL SPECIFICATIONS

Reducing Coupling

Leaded Import Brass Fittings** 125 LB.

Part #	Size (IN.)	Approx. Net WT. (LB.)	A
X112-0604	3/8 x 1/4	0.12	0.92
X112-0806	1/2 x 3/8	0.17	1.17
X112-1206	3/4 x 3/8	0.24	1.35
X112-1208	3/4 x 1/2	0.26	1.35
X112-1612	1 x 3/4	0.45	1.56
X112-2012	1-1/4 x 3/4	0.67	1.77
X112-2408	1-1/2 x 1/2	0.85	1.80
X112-2412	1-1/2 x 3/4	0.92	1.80
X112-2416	1-1/2 x 1	0.90	1.80
X112-2420	1-1/2 x 1-1/4	0.99	1.80
X112-3216	2 x 1	1.39	2.03
X112-3220	2 x 1-1/4	1.05	2.03
X112-4024	2-1/2 x 1-1/2	1.94	3.25
X112-4032	2-1/2 x 2	2.11	3.25
X112-4832	3 x 2	2.40	3.69
X112-4840	3 x 2-1/2	3.01	3.69
X112-6432	4 x 2	3.40	4.38
X112-6448	4 x 3	4.58	4.38

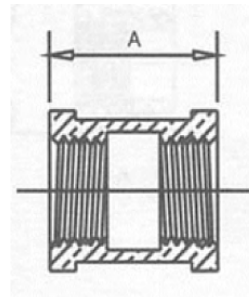

**  **WARNING:** This product can expose you to Lead, which is known to the State of California to cause cancer and birth defects or other reproductive harm. For more information go to www.P65Warnings.ca.gov. This product is not for use in potable water.

DIMENSIONAL SPECIFICATIONS

Hex Bushing

Leaded Import Brass Fittings** 125 LB.

Part #	Size (IN.)	Approx. Net WT. (LB.)	A	B	C	D
X114-0602	3/8 x 1/8	0.10	0.64	0.48	0.39	0.69
X114-0604	3/8 x 1/4	0.10	0.64	0.48	0.24	0.69
X114-0802	1/2 x 1/8	0.10	0.75	0.56	0.50	0.88
X114-0804	1/2 x 1/4	0.09	0.75	0.56	0.43	0.88
X114-0806	1/2 x 3/8	0.07	0.75	0.56	0.34	0.88
X114-1202	3/4 x 1/8	0.19	0.88	0.63	0.25	1.16
X114-1204	3/4 x 1/4	0.17	0.85	0.63	0.53	1.16
X114-1206	3/4 x 3/8	0.16	0.85	0.63	0.49	1.16
X114-1208	3/4 x 1/2	0.11	0.85	0.63	0.32	1.16
X114-1604	1 x 1/4	0.30	1.05	0.75	0.73	1.44
X114-1606	1 x 3/8	0.22	1.05	0.75	0.69	1.13
X114-1608	1 x 1/2	0.21	1.00	0.75	0.57	1.13
X114-1612	1 x 3/4	0.24	1.00	0.75	0.50	1.13
X114-2008	1-1/4 x 1/2	0.47	1.14	0.80	0.71	1.34
X114-2016	1-1/4 x 1	0.39	1.08	0.80	0.47	1.78
X114-2406	1-1/2 x 3/8	0.45	1.14	0.81	0.57	1.78
X114-2412	1-1/2 x 3/4	0.50	1.20	0.83	0.70	1.63
X114-2416	1-1/2 x 1	0.65	1.14	0.83	0.56	2.00
X114-2420	1-1/2 x 1-1/4	0.43	1.14	0.83	0.43	2.00
X114-3208	2 x 1/2	1.10	1.31	0.88	0.88	1.34
X114-3212	2 x 3/4	1.15	1.31	0.88	0.81	1.63
X114-3220	2 x 1-1/4	0.87	1.22	0.88	0.55	2.50
X114-3224	2 x 1-1/2	0.81	1.22	0.88	0.52	2.50
X114-4016	2-1/2 x 1	1.76	1.53	1.09	0.94	1.97
X114-4020	2-1/2 x 1-1/4	1.67	1.53	1.09	0.84	2.97
X114-4032	2-1/2 x 2	1.21	1.44	1.07	0.69	2.41
X114-4824	3 x 1-1/2	2.44	1.63	1.13	0.91	3.50
X114-4832	3 x 2	1.70	1.61	1.13	0.86	3.50
X114-4840	3 x 2-1/2	1.69	1.53	1.13	0.61	3.88

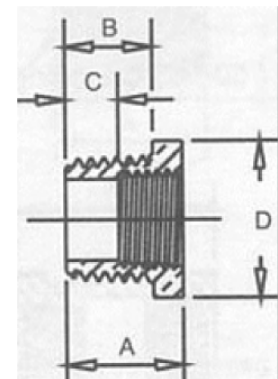

**  **WARNING:** This product can expose you to Lead, which is known to the State of California to cause cancer and birth defects or other reproductive harm. For more information go to www.P65Warnings.ca.gov. This product is not for use in potable water.

DIMENSIONAL SPECIFICATIONS

Square Head Cored Plug

Leaded Import Brass Fittings* 125 LB.

Part #	Size (IN.)	Approx. Net WT. (LB.)	A	B	C
X117-08	1/2	0.09	0.54	0.38	0.56
X117-12	3/4	0.17	0.55	0.44	0.63
X117-16	1	0.26	0.69	0.50	0.81
X117-20	1-1/4	0.38	0.71	0.56	0.94
X117-24	1-1/2	0.52	0.73	0.62	1.13
X117-32	2	0.83	0.76	0.68	1.31
X117-40	2-1/2	1.26	1.07	0.74	1.50
X117-48	3	1.49	1.13	0.80	1.69
X117-64	4	3.41	1.22	0.92	2.25

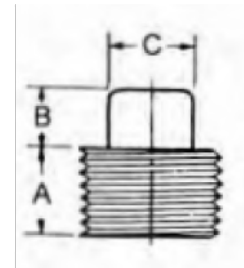

Square Head Solid Plug

Leaded Import Brass Fittings* 125 LB.

Part #	Size (IN.)	Approx. Net WT. (LB.)	A	B	C
X117A-04	1/4	0.10	0.27	0.24	0.28
X117A-06	3/8	0.06	0.41	0.31	0.44
X117A-08	1/2	0.12	0.54	0.38	0.56
X117A-12	3/4	0.18	0.55	0.55	0.63
X117A-16	1	0.35	0.69	0.50	0.81
X117A-20	1-1/4	0.56	0.71	0.56	0.94
X117A-24	1-1/2	0.80	0.73	0.62	1.13
X117A-32	2	1.28	0.76	0.68	1.31
X117A-40	2-1/2	2.35	1.07	0.74	1.50
X117A-48	3	3.59	1.13	0.80	1.69
X117A-64	4	6.82	1.22	0.92	2.25

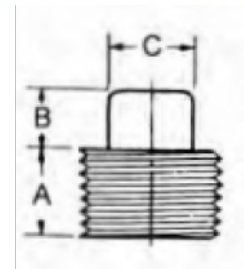

** ⚠️ **WARNING:** This product can expose you to Lead, which is known to the State of California to cause cancer and birth defects or other reproductive harm. For more information go to www.P65Warnings.ca.gov. This product is not for use in potable water.

DIMENSIONAL SPECIFICATIONS

Square Countersunk Plug

Leaded Import Brass Fittings* 125 LB.

Part #	Size (IN.)	Approx. Net WT. (LB.)	A
X118-08	1/2	0.22	0.54
X118-12	3/4	0.38	0.55
X118-16	1	0.47	0.69
X118-20	1-1/4	0.72	0.71
X118-24	1-1/2	1.06	0.73
X118-32	2	1.52	0.76

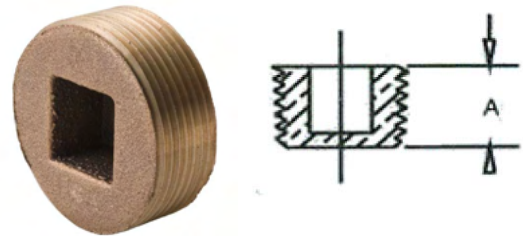

Hex Locknut

Leaded Import Brass Fittings* 125 LB.

Part #	Size (IN.)	Approx. Net WT. (LB.)	A	B
X119-02	1/8	0.02	0.88	0.25
X119-04	1/4	0.03	0.88	0.25
X119-06	3/8	0.04	1.00	0.28
X119-08	1/2	0.10	1.28	0.31
X119-12	3/4	0.13	1.50	0.28
X119-16	1	0.20	1.75	0.34
X119-20	1-1/4	0.29	2.09	0.38
X119-24	1-1/2	0.52	2.44	0.41
X119-32	2	0.64	2.94	0.47

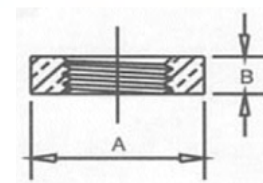

** ⚠ **WARNING:** This product can expose you to Lead, which is known to the State of California to cause cancer and birth defects or other reproductive harm. For more information go to www.P65Warnings.ca.gov. This product is not for use in potable water.

DIMENSIONAL SPECIFICATIONS

Union

Leaded Import Brass Fittings* 125 LB.

Part #	Size (IN.)	Approx. Net WT. (LB.)	A
X187-04	1/4	0.22	1.25
X187-06	3/8	0.38	1.48
X187-08	1/2	0.47	1.56
X187-12	3/4	0.72	1.87
X187-16	1	1.06	2.11
X187-20	1-1/4	1.52	2.34
X187-24	1-1/2	2.09	2.65
X187-32	2	3.12	2.96

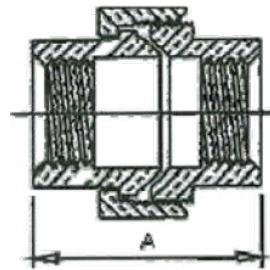

Union

Leaded Import Brass Fittings* 250 LB.

Part #	Size (IN.)	Approx. Net WT. (LB.)	A
X190-02	1/8	0.19	0.44
X190-04	1/4	0.35	1.56
X190-06	3/8	0.41	1.75
X190-08	1/2	0.62	2.00
X190-12	3/4	1.06	2.13
X190-16	1	1.40	2.44
X190-20	1-1/4	2.29	2.69
X190-24	1-1/2	2.94	2.81
X190-32	2	3.42	3.19
X190-40	2-1/2	5.79	3.63

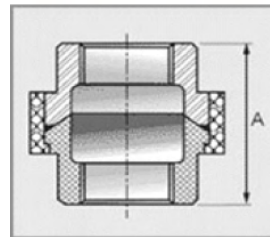

**** ⚠ WARNING:** This product can expose you to Lead, which is known to the State of California to cause cancer and birth defects or other reproductive harm. For more information go to www.P65Warnings.ca.gov. This product is not for use in potable water.

DIMENSIONAL SPECIFICATIONS

Floor Flange

Leaded Import Brass Fittings* 125 LB.

Part #	Size (IN.)	Approx. Net WT. (LB.)	A	B
X240-08	1/2	0.65	3.52	0.55
X240-12	3/4	0.70	3.52	0.62
X240-16	1	0.89	4.02	0.70
X240-20	1-1/4	0.94	4.02	0.76
X240-24	1-1/2	1.24	4.53	0.89
X240-32	2	1.71	5.54	1.00

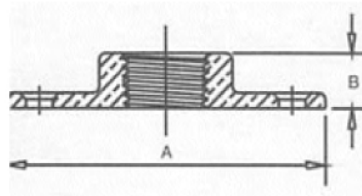

**** ⚠ WARNING:** This product can expose you to Lead, which is known to the State of California to cause cancer and birth defects or other reproductive harm. For more information go to www.P65Warnings.ca.gov. This product is not for use in potable water.

LOCATIONS

SPARKS DISTRIBUTION CENTER
200 Vista Boulevard Suite #106
Sparks, NV 89434

LONG BEACH PIPE DEPOT
2396 E. Artesia Blvd
Long Beach, CA 90805

DALLAS DISTRIBUTION CENTER
10614 King William Drive
Dallas, TX 75220

CLEVELAND HEADQUARTERS
One Merit Drive/PO Box 43127
Cleveland, OH 44143

BIRMINGHAM DISTRIBUTION CENTER
220 Oxmoor Court
Birmingham, AL 35209

HOUSTON DISTRIBUTION CENTER
4680 S. Sam Houston Pkwy W, Suite 120
Houston, TX 77053

SHIPPING TIMES

UPS

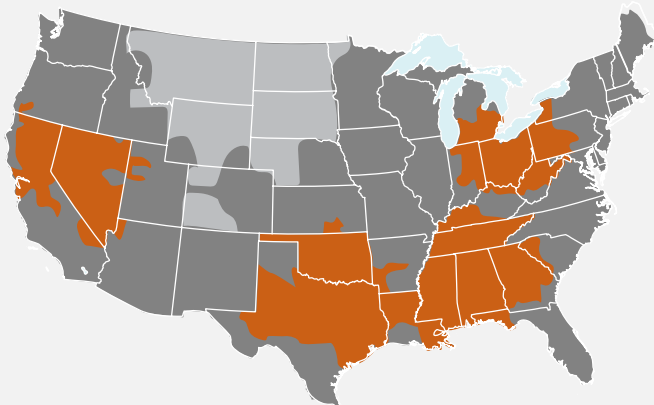

1 Day 2 Days 3 Days

FedEx

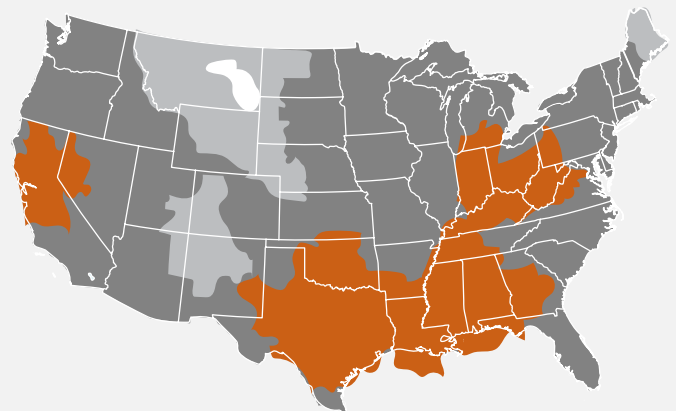

1 Day 2 Days 3 Days 4 Days

*FedEx is Merit's Primary Carrier

LEARN MORE



800.726.9800

Follow us on

WWW.MERITBRASS.COM

www.mbwebxpress.com

contactus@meritbrass.com

Merit Brass Headquarters Has An ISO 9001:2015 Registered Quality Management System