

IMPORT BRASS FITTINGS (LEADED)

Nominal Pipe Size

1/8" – 4"

Description

This specification covers Import Brass Fittings used in piping applications as determined by the End User as a function of what is being transported in the system, pressure ratings, temperature of ratings and line pressure.

Specifications

Import Brass Fittings provided by Merit Brass Co. shall conform to ASME B16.15 (Cast Copper Alloy Threaded Fittings: Classes 125 and 150) from Copper Alloy C83600 that is in accordance with ASTM B62 (Standard Specification for Composition Bronze or Ounce Metal Castings). Fittings are threaded with American Standard Tapered Pipe Threads (NPT) in accordance with ASME B1.20.1 (Pipe Threads, General Purpose).

Fitting Type

- 45° Elbow
- 45° Street Elbow
- 90° Elbow
- 90° Street Elbow
- 90° Reducing Elbow
- Tee
- Reducing Tee
- Cross
- End Cap
- Coupling
- Reducing Coupling
- Hex Bushing
- Square Head Plug (Cored)
- Square Head Plug (Solid)
- Hex Locknut
- Union

Project Information	Approval Stamp
Project Name:	Approved
Project Location:	Approved As Noted
Project Contractor:	Not Approved
Project Engineer:	Remarks:
Project Distributor:	
Project Rep:	
Submittal Date:	
Notes 1:	
Notes 2:	

Every precaution has been taken in preparing this submittal, however, Merit Brass Company cannot be held responsible for typographical errors or omissions. Some items and sizes may be discontinued when stock is depleted and may require a minimum order quantity. Please visit meritbrass.com. Certain inventory limitations may apply. Contact our Sales Team for details at 800.726.9800 or contactus@meritbrass.com.

DIMENSIONAL SPECIFICATIONS

90° Elbow

Leaded Import Brass Fittings** 125 LB.

Part #	Size (IN.)	Approx. Net WT. (LB.)	A	B
X101-02	1/8	0.07	0.54	0.54
X101-04	1/4	0.13	0.71	0.71
X101-06	3/8	0.17	0.82	0.82
X101-08	1/2	0.22	1.01	1.01
X101-12	3/4	0.37	1.18	1.18
X101-16	1	0.52	1.43	1.43
X101-20	1-1/4	0.96	1.69	1.69
X101-24	1-1/2	1.16	1.84	1.84
X101-32	2	2.07	2.12	2.12
X101-40	2-1/2	3.83	2.70	2.70
X101-48	3	4.62	3.08	3.08
X101-64	4	7.70	3.79	3.79

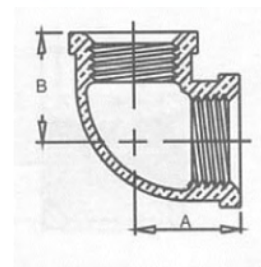

90° Elbow

Leaded Import Brass Fittings** 250 LB.

Part #	Size (IN.)	Approx. Net WT. (LB.)	A	B
X150-04	1/4	0.16	0.81	0.32
X150-06	3/8	0.26	0.95	0.36
X150-08	1/2	0.43	1.12	0.43
X150-12	3/4	0.67	1.31	0.50
X150-16	1	1.05	1.50	0.58
X150-20	1-1/4	1.68	1.75	0.67
X150-24	1-1/2	2.15	1.94	0.70
X150-32	2	3.52	2.25	0.75
X150-40	2-1/2	5.43	2.70	0.92
X150-48	3	7.99	3.08	1.08

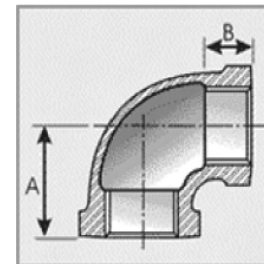

**  **WARNING:** This product can expose you to Lead, which is known to the State of California to cause cancer and birth defects or other reproductive harm. For more information go to www.P65Warnings.ca.gov. This product is not for use in potable water.

DIMENSIONAL SPECIFICATIONS

90° Street Elbow

Leaded Import Brass Fittings** 125 LB.

Part #	Size (IN.)	Approx. Net WT. (LB.)	A	B
X103-02	1/8	0.06	0.55	0.92
X103-04	1/4	0.11	0.72	1.11
X103-06	3/8	0.17	0.83	1.24
X103-08	1/2	0.21	1.03	1.51
X103-12	3/4	0.31	1.19	1.66
X103-16	1	0.63	1.43	1.98
X103-20	1-1/4	1.03	1.71	2.26
X103-24	1-1/2	1.27	1.87	2.46
X103-32	2	2.09	2.14	2.98
X103-40	2-1/2	4.05	2.74	3.92
X103-48	3	6.38	3.10	4.45

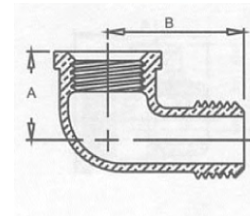

90° Street Elbow

Leaded Import Brass Fittings** 250 LB.

Part #	Size (IN.)	Approx. Net WT. (LB.)	A	B	C
X160-04	1/4	0.20	0.81	1.11	0.40
X160-06	3/8	0.20	0.94	1.24	0.40
X160-08	1/2	0.33	1.22	1.49	0.53
X160-12	3/4	0.56	1.31	1.69	0.55
X160-16	1	0.89	1.50	1.98	0.68
X160-20	1-1/4	1.45	1.75	2.24	0.74
X160-24	1-1/2	1.95	1.94	2.48	0.75
X160-32	2	3.01	2.25	2.88	0.75

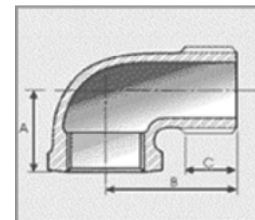

**  **WARNING:** This product can expose you to Lead, which is known to the State of California to cause cancer and birth defects or other reproductive harm. For more information go to www.P65Warnings.ca.gov. This product is not for use in potable water.

DIMENSIONAL SPECIFICATIONS

90° Reducing Elbow

Leaded Import Brass Fittings** 125 LB.

Part #	Size (IN.)	Approx. Net WT. (LB.)	A	B
X101-0402	1/4 x 1/8	0.10	0.65	0.60
X101-0604	3/8 x 1/4	0.15	0.75	0.75
X101-0804	1/2 x 1/4	0.19	1.78	1.69
X101-0806	1/2 x 3/8	0.23	0.93	0.90
X101-1204	3/4 x 1/4	0.26	1.00	1.00
X101-1206	3/4 x 3/8	0.30	0.97	0.97
X101-1208	3/4 x 1/2	0.31	1.08	1.11
X101-1608	1 x 1/2	0.53	1.20	1.24
X101-1612	1 x 3/4	0.59	1.30	1.31
X101-2008	1-1/4 x 1/2	0.61	1.25	1.38
X101-2016	1-1/4 x 1	0.81	1.52	1.60
X101-2412	1-1/2 x 3/4	0.83	1.50	1.75
X101-2416	1-1/2 x 1	0.98	1.55	1.72
X101-2420	1-1/2 x 1-1/4	1.22	1.72	1.81
X101-3208	2 x 1/2	1.10	1.17	2.92
X101-3216	2 x 1	1.30	1.56	1.94
X101-3220	2 x 1-1/4	1.51	1.75	2.06
X101-3224	2 x 1-1/2	1.69	1.89	2.07
X101-4032	2-1/2 x 2	2.99	2.39	2.60
X101-4832	3 x 2	3.63	2.50	2.88
X101-4840	3 x 2-1/2	4.09	2.83	2.99

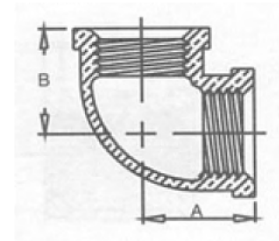

**  **WARNING:** This product can expose you to Lead, which is known to the State of California to cause cancer and birth defects or other reproductive harm. For more information go to www.P65Warnings.ca.gov. This product is not for use in potable water.

DIMENSIONAL SPECIFICATIONS

45° Elbow

Leaded Import Brass Fittings** 125 LB.

Part #	Size (IN.)	Approx. Net WT. (LB.)	A	B
X102-02	1/8	0.07	0.43	0.43
X102-04	1/4	0.11	0.55	0.55
X102-06	3/8	0.12	0.63	0.63
X102-08	1/2	0.25	0.79	0.79
X102-12	3/4	0.34	0.91	0.91
X102-16	1	0.54	1.07	1.07
X102-20	1-1/4	0.90	1.23	1.23
X102-24	1-1/2	1.03	1.31	1.31
X102-32	2	1.54	1.47	1.47
X102-40	2-1/2	3.30	1.89	1.89
X102-48	3	3.52	2.18	2.18

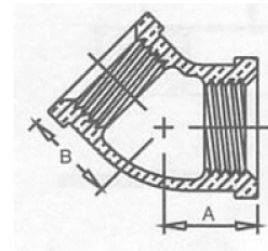

45° Elbow

Leaded Import Brass Fittings** 250 LB.

Part #	Size (IN.)	Approx. Net WT. (LB.)	A	B
X152-08	1/2	0.39	1.12	0.43
X152-12	3/4	0.62	1.31	0.50
X152-16	1	0.91	1.50	0.58
X152-20	1-1/4	1.45	1.75	0.67
X152-24	1-1/2	1.96	1.94	0.70
X152-32	2	3.14	2.25	0.75

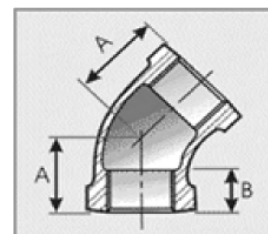

**  **WARNING:** This product can expose you to Lead, which is known to the State of California to cause cancer and birth defects or other reproductive harm. For more information go to www.P65Warnings.ca.gov. This product is not for use in potable water.

DIMENSIONAL SPECIFICATIONS

45° Street Elbow

Leaded Import Brass Fittings** 125 LB.

Part #	Size (IN.)	Approx. Net WT. (LB.)	A	B
X103A-04	1/4	0.09	0.56	0.88
X103A-06	3/8	0.14	0.63	0.92
X103A-08	1/2	0.29	0.78	1.06
X103A-12	3/4	0.31	0.89	1.23
X103A-16	1	0.52	1.06	1.40
X103A-20	1-1/4	0.77	1.22	1.64
X103A-24	1-1/2	0.97	1.30	1.80
X103A-32	2	2.04	1.45	2.14

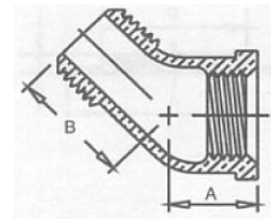

Tee

Leaded Import Brass Fittings** 125 LB.

Part #	Size (IN.)	Approx. Net WT. (LB.)	A	B	C
X106-02	1/8	0.09	0.54	0.54	0.54
X106-04	1/4	0.16	0.71	0.71	0.71
X106-06	3/8	0.24	0.82	0.82	0.82
X106-08	1/2	0.29	1.01	1.01	1.01
X106-12	3/4	0.44	1.18	1.18	1.18
X106-16	1	0.77	1.43	1.43	1.43
X106-20	1-1/4	1.18	1.69	1.69	1.69
X106-24	1-1/2	1.56	1.84	1.84	1.84
X106-32	2	2.62	2.12	2.12	2.12
X106-40	2-1/2	5.28	2.70	2.70	2.70
X106-48	3	5.98	3.08	3.08	3.08
X106-64	4	10.78	3.79	3.79	3.79

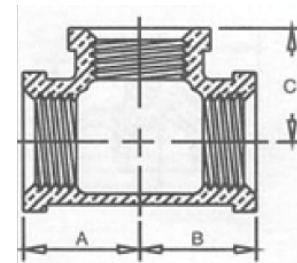

**  **WARNING:** This product can expose you to Lead, which is known to the State of California to cause cancer and birth defects or other reproductive harm. For more information go to www.P65Warnings.ca.gov. This product is not for use in potable water.

DIMENSIONAL SPECIFICATIONS

Tee

Leaded Import Brass Fittings** 250 LB.

Part #	Size (IN.)	Approx. Net WT. (LB.)	A	B	C
X153-04	1/4	0.24	0.81	0.93	0.38
X153-06	3/8	0.37	0.95	1.12	0.44
X153-08	1/2	0.61	1.12	1.34	0.50
X153-12	3/4	0.97	1.31	1.63	0.56
X153-16	1	1.47	1.50	1.95	0.62
X153-20	1-1/4	2.23	1.75	2.39	0.69
X153-24	1-1/2	3.01	1.94	2.68	0.75
X153-32	2	4.79	2.25	3.28	0.84
X153-40	2-1/2	7.19	2.70	3.86	0.94
X153-48	3	10.84	3.08	4.62	1.00

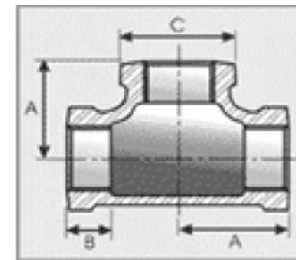

Reducing Tee

Leaded Import Brass Fittings** 125 LB.

Part #	Size (IN.)	Approx. Net WT. (LB.)	A	B	C
X106-040402	1/4 x 1/4 x 1/8	0.14	0.65	0.65	0.60
X106-060604	3/8 x 3/8 x 1/4	0.21	0.75	0.75	0.78
X106-080408	1/2 x 1/4 x 1/2	0.28	0.93	0.87	0.93
X106-080806	1/2 x 1/2 x 3/8	0.32	0.93	0.93	0.90
X106-080812	1/2 x 1/2 x 3/4	0.47	1.11	1.11	1.08
X106-120808	3/4 x 1/2 x 1/2	0.43	1.08	1.01	1.11
X106-120812	3/4 x 1/2 x 3/4	0.49	1.18	1.11	1.18
X106-121204	3/4 x 3/4 x 1/4	0.38	1.00	1.00	1.00
X106-121206	3/4 x 3/4 x 3/8	0.46	1.00	1.00	1.00
X106-121208	3/4 x 3/4 x 1/2	0.53	1.08	1.08	1.11
X106-121216	3/4 x 3/4 x 1	0.73	1.31	1.31	1.30
X106-160808	1 x 1/2 x 1/2	0.43	1.31	1.22	1.31

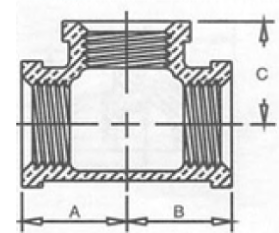

**  **WARNING:** This product can expose you to Lead, which is known to the State of California to cause cancer and birth defects or other reproductive harm. For more information go to www.P65Warnings.ca.gov. This product is not for use in potable water.

DIMENSIONAL SPECIFICATIONS

Reducing Tee (Continued)

Leaded Import Brass Fittings** 125 LB.

Part #	Size (IN.)	Approx. Net WT. (LB.)	A	B	C
X106-160812	1 x 1/2 x 3/4	0.49	1.30	1.11	1.31
X106-160816	1 x 1/2 x 1	0.73	1.43	1.24	1.43
X106-161208	1 x 3/4 x 1/2	0.67	1.20	1.08	1.24
X106-161212	1 x 3/4 x 3/4	0.70	1.30	1.08	1.31
X106-161606	1 x 1 x 3/8	0.63	1.12	1.12	1.13
X106-161608	1 x 1 x 1/2	0.73	1.20	1.20	1.24
X106-161612	1 x 1 x 3/4	0.83	1.30	1.30	1.31
X106-161620	1 x 1 x 1-1/4	0.97	1.60	1.60	1.52
X106-200820	1-1/4 x 1/2 x 1-1/4	1.05	1.69	1.40	1.69
X106-202008	1-1/4 x 1-1/4 x 1/2	1.05	1.29	1.29	1.41
X106-202012	1-1/4 x 1-1/4 x 3/4	1.04	1.39	1.39	1.48
X106-202016	1-1/4 x 1-1/4 x 1	1.12	1.52	1.52	1.60
X106-240824	1-1/2 x 1/2 x 1-1/2	1.11	1.81	1.56	1.81
X106-242408	1-1/2 x 1-1/2 x 1/2	1.11	1.32	1.32	1.53
X106-242412	1-1/2 x 1-1/2 x 3/4	1.23	1.42	1.42	1.60
X106-242416	1-1/2 x 1-1/2 x 1	1.31	1.55	1.55	1.72
X106-242420	1-1/2 x 1-1/2 x 1-1/4	1.52	1.72	1.72	1.81
X106-323208	2 x 2 x 1/2	1.65	1.50	1.50	1.88
X106-323212	2 x 2 x 3/4	1.87	1.47	1.47	1.84
X106-323216	2 x 2 x 1	1.91	1.59	1.59	1.95
X106-323220	2 x 2 x 1-1/4	2.15	1.77	1.77	2.04
X106-323224	2 x 2 x 1-1/2	3.08	1.89	1.89	2.07
X106-404016	2-1/2 x 2-1/2 x 1	4.07	1.88	1.88	2.38
X106-404032	2-1/2 x 2-1/2 x 2	4.07	2.39	2.39	2.60
X106-484832	3 x 3 x 2	4.36	2.52	2.52	2.89
X106-484840	3 x 3 x 2-1/2	5.50	2.83	2.83	2.99
X106-646432	4 x 4 x 2	7.59	2.75	2.75	3.41

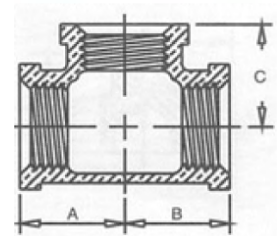

**  **WARNING:** This product can expose you to Lead, which is known to the State of California to cause cancer and birth defects or other reproductive harm. For more information go to www.P65Warnings.ca.gov. This product is not for use in potable water.

DIMENSIONAL SPECIFICATIONS

Cross

Leaded Import Brass Fittings** 125 LB.

Part #	Size (IN.)	Approx. Net WT. (LB.)	A	B
X110-02	1/8	0.13	0.54	0.54
X110-04	1/4	0.20	0.71	0.71
X110-06	3/8	0.29	0.82	0.82
X110-08	1/2	0.43	1.01	1.01
X110-12	3/4	0.68	1.18	1.18
X110-16	1	1.08	1.43	1.43
X110-20	1-1/4	1.70	1.69	1.69
X110-24	1-1/2	1.97	1.84	1.84
X110-32	2	2.52	2.12	2.12
X110-40	2-1/2	5.73	2.70	2.70

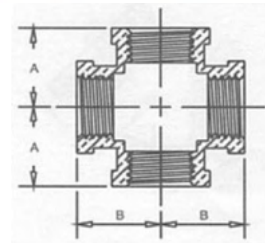

Cross

Leaded Import Brass Fittings** 250 LB.

Part #	Size (IN.)	Approx. Net WT. (LB.)	A	B
X154-04	1/4	0.32	0.81	0.93
X154-06	3/8	0.4	0.95	1.12
X154-08	1/2	0.75	1.12	1.34
X154-12	3/4	1.25	1.31	1.63
X154-16	1	1.9	1.50	1.95
X154-20	1-1/4	2.85	1.75	2.39
X154-24	1-1/2	3.85	1.94	2.68
X154-32	2	5.9	2.25	3.28

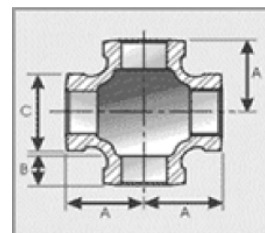

**  **WARNING:** This product can expose you to Lead, which is known to the State of California to cause cancer and birth defects or other reproductive harm. For more information go to www.P65Warnings.ca.gov. This product is not for use in potable water.

DIMENSIONAL SPECIFICATIONS

Cap

Leaded Import Brass Fittings** 125 LB.

Part #	Size (IN.)	Approx. Net WT. (LB.)	A
X116-02	1/8	0.04	0.49
X116-04	1/4	0.07	0.59
X116-06	3/8	0.09	0.66
X116-08	1/2	0.13	0.78
X116-12	3/4	0.22	0.84
X116-16	1	0.40	1.00
X116-20	1-1/4	0.48	1.13
X116-24	1-1/2	0.72	1.16
X116-32	2	1.11	1.34
X116-40	2-1/2	1.75	1.72
X116-48	3	2.71	1.81
X116-64	4	3.76	2.09

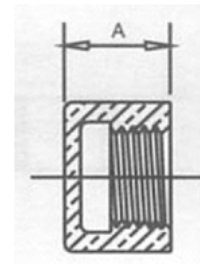

Cap

Leaded Import Brass Fittings** 250 LB.

Part #	Size (IN.)	Approx. Net WT. (LB.)	A	B
X158-04	1/4	0.09	0.32	0.67
X158-06	3/8	0.15	0.36	0.76
X158-08	1/2	0.22	0.44	0.86
X158-12	3/4	0.37	0.51	1.02
X158-16	1	0.54	0.58	1.10
X158-20	1-1/4	0.87	0.68	1.29
X158-24	1-1/2	1.12	0.70	1.33
X158-32	2	1.80	0.75	1.55
X158-40	2-1/2	4.19	0.92	1.81

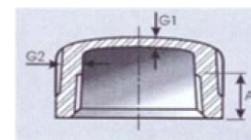

**  **WARNING:** This product can expose you to Lead, which is known to the State of California to cause cancer and birth defects or other reproductive harm. For more information go to www.P65Warnings.ca.gov. This product is not for use in potable water.

DIMENSIONAL SPECIFICATIONS

Coupling

Leaded Import Brass Fittings** 125 LB.

Part #	Size (IN.)	Approx. Net WT. (LB.)	A
X111-02	1/8	0.06	0.80
X111-04	1/4	0.10	0.80
X111-06	3/8	0.14	1.05
X111-08	1/2	0.19	1.29
X111-12	3/4	0.29	1.43
X111-16	1	0.45	1.68
X111-20	1-1/4	0.56	1.86
X111-24	1-1/2	1.03	1.92
X111-32	2	1.06	2.20
X111-40	2-1/2	2.77	2.88
X111-48	3	2.75	3.18

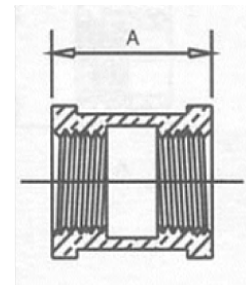

Coupling

Leaded Import Brass Fittings** 250 LB.

Part #	Size (IN.)	Approx. Net WT. (LB.)	A	B
X157-04	1/4	0.14	0.32	1.06
X157-06	3/8	0.22	0.36	1.16
X157-08	1/2	0.33	0.44	1.35
X157-12	3/4	0.54	0.51	1.53
X157-16	1	0.79	0.58	1.68
X157-20	1-1/4	1.26	0.68	1.95
X157-24	1-1/2	1.71	0.70	2.15
X157-32	2	2.73	0.70	2.54
X157-40	2-1/2	4.11	0.92	2.90
X157-48	3	5.98	1.00	3.20

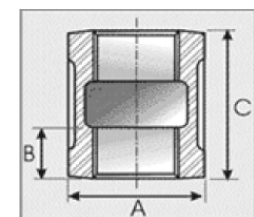

**** ⚠ WARNING:** This product can expose you to Lead, which is known to the State of California to cause cancer and birth defects or other reproductive harm. For more information go to www.P65Warnings.ca.gov. This product is not for use in potable water.

DIMENSIONAL SPECIFICATIONS

Reducing Coupling

Leaded Import Brass Fittings** 125 LB.

Part #	Size (IN.)	Approx. Net WT. (LB.)	A
X112-0604	3/8 x 1/4	0.12	0.92
X112-0806	1/2 x 3/8	0.17	1.17
X112-1206	3/4 x 3/8	0.24	1.35
X112-1208	3/4 x 1/2	0.26	1.35
X112-1612	1 x 3/4	0.45	1.56
X112-2012	1-1/4 x 3/4	0.67	1.77
X112-2408	1-1/2 x 1/2	0.85	1.80
X112-2412	1-1/2 x 3/4	0.92	1.80
X112-2416	1-1/2 x 1	0.90	1.80
X112-2420	1-1/2 x 1-1/4	0.99	1.80
X112-3216	2 x 1	1.39	2.03
X112-3220	2 x 1-1/4	1.05	2.03
X112-4024	2-1/2 x 1-1/2	1.94	3.25
X112-4032	2-1/2 x 2	2.11	3.25
X112-4832	3 x 2	2.40	3.69
X112-4840	3 x 2-1/2	3.01	3.69
X112-6432	4 x 2	3.40	4.38
X112-6448	4 x 3	4.58	4.38

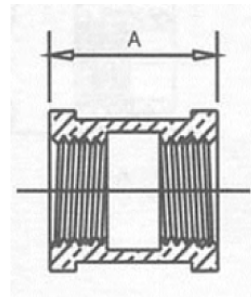

**  **WARNING:** This product can expose you to Lead, which is known to the State of California to cause cancer and birth defects or other reproductive harm. For more information go to www.P65Warnings.ca.gov. This product is not for use in potable water.

DIMENSIONAL SPECIFICATIONS

Hex Bushing

Leaded Import Brass Fittings** 125 LB.

Part #	Size (IN.)	Approx. Net WT. (LB.)	A	B	C	D
X114-0602	3/8 x 1/8	0.10	0.64	0.48	0.39	0.69
X114-0604	3/8 x 1/4	0.10	0.64	0.48	0.24	0.69
X114-0802	1/2 x 1/8	0.10	0.75	0.56	0.50	0.88
X114-0804	1/2 x 1/4	0.09	0.75	0.56	0.43	0.88
X114-0806	1/2 x 3/8	0.07	0.75	0.56	0.34	0.88
X114-1202	3/4 x 1/8	0.19	0.88	0.63	0.25	1.16
X114-1204	3/4 x 1/4	0.17	0.85	0.63	0.53	1.16
X114-1206	3/4 x 3/8	0.16	0.85	0.63	0.49	1.16
X114-1208	3/4 x 1/2	0.11	0.85	0.63	0.32	1.16
X114-1604	1 x 1/4	0.30	1.05	0.75	0.73	1.44
X114-1606	1 x 3/8	0.22	1.05	0.75	0.69	1.13
X114-1608	1 x 1/2	0.21	1.00	0.75	0.57	1.13
X114-1612	1 x 3/4	0.24	1.00	0.75	0.50	1.13
X114-2008	1-1/4 x 1/2	0.47	1.14	0.80	0.71	1.34
X114-2016	1-1/4 x 1	0.39	1.08	0.80	0.47	1.78
X114-2406	1-1/2 x 3/8	0.45	1.14	0.81	0.57	1.78
X114-2412	1-1/2 x 3/4	0.50	1.20	0.83	0.70	1.63
X114-2416	1-1/2 x 1	0.65	1.14	0.83	0.56	2.00
X114-2420	1-1/2 x 1-1/4	0.43	1.14	0.83	0.43	2.00
X114-3208	2 x 1/2	1.10	1.31	0.88	0.88	1.34
X114-3212	2 x 3/4	1.15	1.31	0.88	0.81	1.63
X114-3220	2 x 1-1/4	0.87	1.22	0.88	0.55	2.50
X114-3224	2 x 1-1/2	0.81	1.22	0.88	0.52	2.50
X114-4016	2-1/2 x 1	1.76	1.53	1.09	0.94	1.97
X114-4020	2-1/2 x 1-1/4	1.67	1.53	1.09	0.84	2.97
X114-4032	2-1/2 x 2	1.21	1.44	1.07	0.69	2.41
X114-4824	3 x 1-1/2	2.44	1.63	1.13	0.91	3.50
X114-4832	3 x 2	1.70	1.61	1.13	0.86	3.50
X114-4840	3 x 2-1/2	1.69	1.53	1.13	0.61	3.88

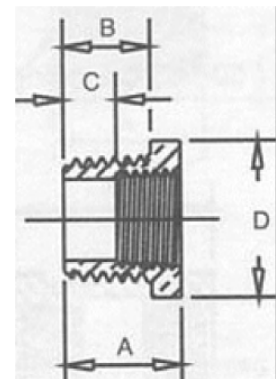

**  **WARNING:** This product can expose you to Lead, which is known to the State of California to cause cancer and birth defects or other reproductive harm. For more information go to www.P65Warnings.ca.gov. This product is not for use in potable water.

DIMENSIONAL SPECIFICATIONS

Square Head Cored Plug

Leaded Import Brass Fittings* 125 LB.

Part #	Size (IN.)	Approx. Net WT. (LB.)	A	B	C
X117-08	1/2	0.09	0.54	0.38	0.56
X117-12	3/4	0.17	0.55	0.44	0.63
X117-16	1	0.26	0.69	0.50	0.81
X117-20	1-1/4	0.38	0.71	0.56	0.94
X117-24	1-1/2	0.52	0.73	0.62	1.13
X117-32	2	0.83	0.76	0.68	1.31
X117-40	2-1/2	1.26	1.07	0.74	1.50
X117-48	3	1.49	1.13	0.80	1.69
X117-64	4	3.41	1.22	0.92	2.25

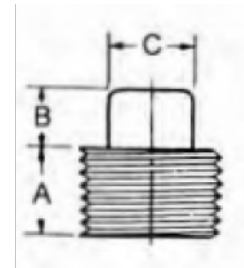

Square Head Solid Plug

Leaded Import Brass Fittings* 125 LB.

Part #	Size (IN.)	Approx. Net WT. (LB.)	A	B	C
X117A-04	1/4	0.10	0.27	0.24	0.28
X117A-06	3/8	0.06	0.41	0.31	0.44
X117A-08	1/2	0.12	0.54	0.38	0.56
X117A-12	3/4	0.18	0.55	0.55	0.63
X117A-16	1	0.35	0.69	0.50	0.81
X117A-20	1-1/4	0.56	0.71	0.56	0.94
X117A-24	1-1/2	0.80	0.73	0.62	1.13
X117A-32	2	1.28	0.76	0.68	1.31
X117A-40	2-1/2	2.35	1.07	0.74	1.50
X117A-48	3	3.59	1.13	0.80	1.69
X117A-64	4	6.82	1.22	0.92	2.25

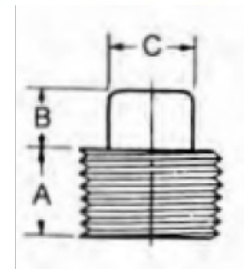

** ⚠️ **WARNING:** This product can expose you to Lead, which is known to the State of California to cause cancer and birth defects or other reproductive harm. For more information go to www.P65Warnings.ca.gov. This product is not for use in potable water.

DIMENSIONAL SPECIFICATIONS

Square Countersunk Plug

Leaded Import Brass Fittings* 125 LB.

Part #	Size (IN.)	Approx. Net WT. (LB.)	A
X118-08	1/2	0.22	0.54
X118-12	3/4	0.38	0.55
X118-16	1	0.47	0.69
X118-20	1-1/4	0.72	0.71
X118-24	1-1/2	1.06	0.73
X118-32	2	1.52	0.76

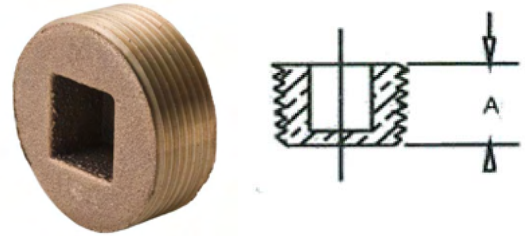

Hex Locknut

Leaded Import Brass Fittings* 125 LB.

Part #	Size (IN.)	Approx. Net WT. (LB.)	A	B
X119-02	1/8	0.02	0.88	0.25
X119-04	1/4	0.03	0.88	0.25
X119-06	3/8	0.04	1.00	0.28
X119-08	1/2	0.10	1.28	0.31
X119-12	3/4	0.13	1.50	0.28
X119-16	1	0.20	1.75	0.34
X119-20	1-1/4	0.29	2.09	0.38
X119-24	1-1/2	0.52	2.44	0.41
X119-32	2	0.64	2.94	0.47

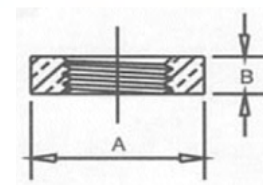

**** ⚠ WARNING:** This product can expose you to Lead, which is known to the State of California to cause cancer and birth defects or other reproductive harm. For more information go to www.P65Warnings.ca.gov. This product is not for use in potable water.

DIMENSIONAL SPECIFICATIONS

Union

Leaded Import Brass Fittings* 125 LB.

Part #	Size (IN.)	Approx. Net WT. (LB.)	A
X187-04	1/4	0.22	1.25
X187-06	3/8	0.38	1.48
X187-08	1/2	0.47	1.56
X187-12	3/4	0.72	1.87
X187-16	1	1.06	2.11
X187-20	1-1/4	1.52	2.34
X187-24	1-1/2	2.09	2.65
X187-32	2	3.12	2.96

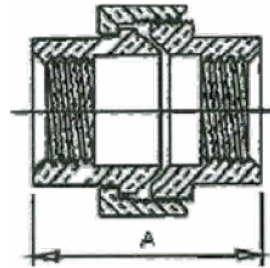

Union

Leaded Import Brass Fittings* 250 LB.

Part #	Size (IN.)	Approx. Net WT. (LB.)	A
X190-02	1/8	0.19	0.44
X190-04	1/4	0.35	1.56
X190-06	3/8	0.41	1.75
X190-08	1/2	0.62	2.00
X190-12	3/4	1.06	2.13
X190-16	1	1.40	2.44
X190-20	1-1/4	2.29	2.69
X190-24	1-1/2	2.94	2.81
X190-32	2	3.42	3.19
X190-40	2-1/2	5.79	3.63

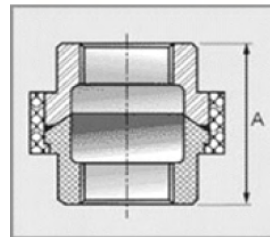

** ⚠ **WARNING:** This product can expose you to Lead, which is known to the State of California to cause cancer and birth defects or other reproductive harm. For more information go to www.P65Warnings.ca.gov. This product is not for use in potable water.

DIMENSIONAL SPECIFICATIONS

Floor Flange

Leaded Import Brass Fittings* 125 LB.

Part #	Size (IN.)	Approx. Net WT. (LB.)	A	B
X240-08	1/2	0.65	3.52	0.55
X240-12	3/4	0.70	3.52	0.62
X240-16	1	0.89	4.02	0.70
X240-20	1-1/4	0.94	4.02	0.76
X240-24	1-1/2	1.24	4.53	0.89
X240-32	2	1.71	5.54	1.00

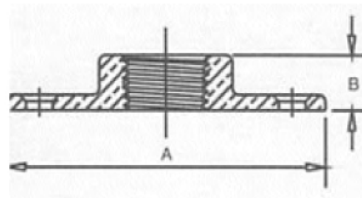

**** ⚠ WARNING:** This product can expose you to Lead, which is known to the State of California to cause cancer and birth defects or other reproductive harm. For more information go to www.P65Warnings.ca.gov. This product is not for use in potable water.

LOCATIONS

SPARKS DISTRIBUTION CENTER
200 Vista Boulevard Suite #106
Sparks, NV 89434

LONG BEACH PIPE DEPOT
2396 E. Artesia Blvd
Long Beach, CA 90805

DALLAS DISTRIBUTION CENTER
10614 King William Drive
Dallas, TX 75220

CLEVELAND HEADQUARTERS
One Merit Drive/PO Box 43127
Cleveland, OH 44143

BIRMINGHAM DISTRIBUTION CENTER
220 Oxmoor Court
Birmingham, AL 35209

HOUSTON DISTRIBUTION CENTER
4680 S. Sam Houston Pkwy W, Suite 120
Houston, TX 77053

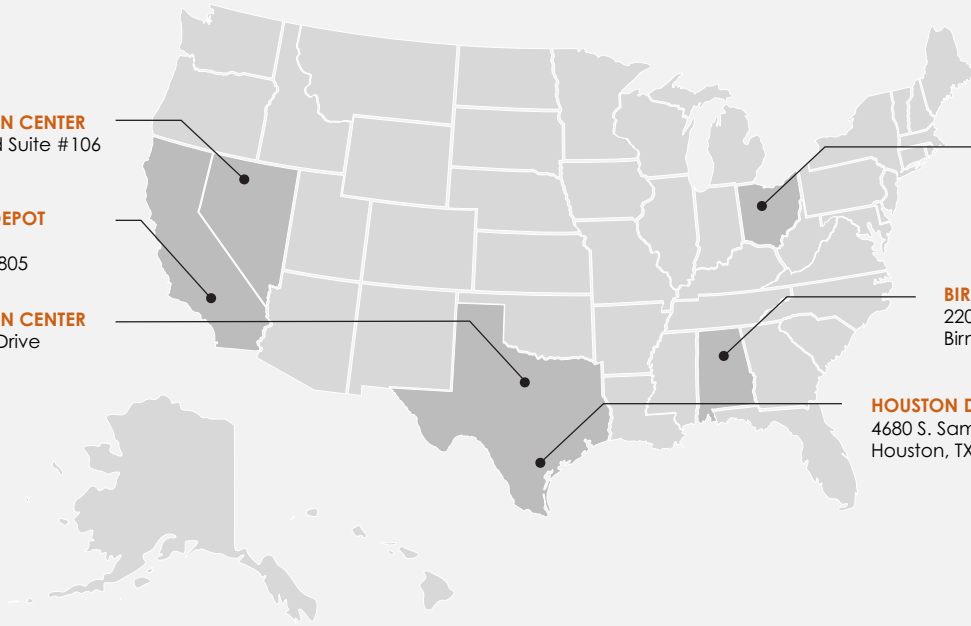

SHIPPING TIMES

UPS

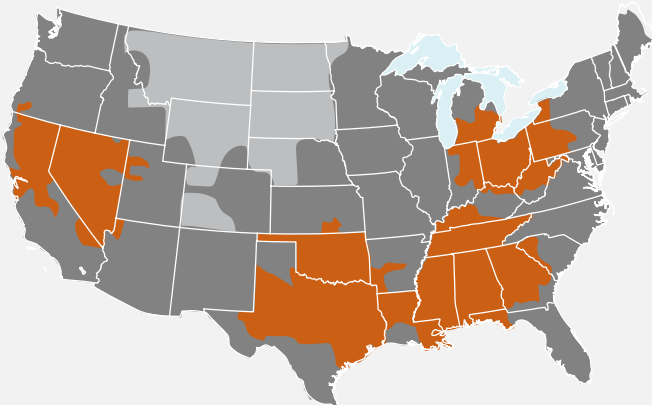

1 Day 2 Days 3 Days

FedEx

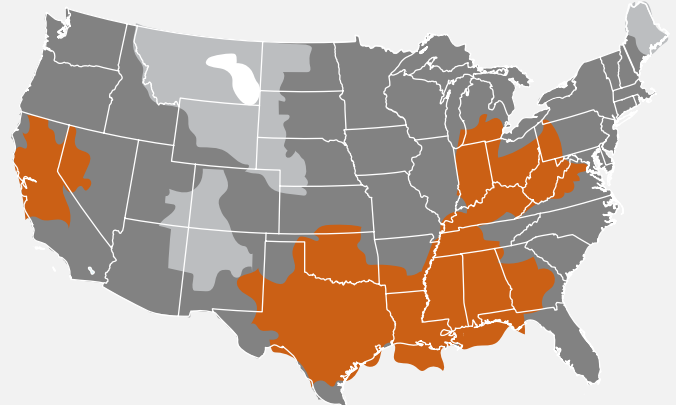

1 Day 2 Days 3 Days 4 Days

*FedEx is Merit's Primary Carrier

LEARN MORE



800.726.9800

Follow us on      

www.meritbrass.com
www.mbwebxpress.com
contactus@meritbrass.com

Merit Brass Headquarters Has An ISO 9001:2015 Registered Quality Management System