

STAINLESS STEEL VALVES

3-PC Stainless Steel Ball Valve – Full Port 1000 WOG

V310FP/SWV310FP

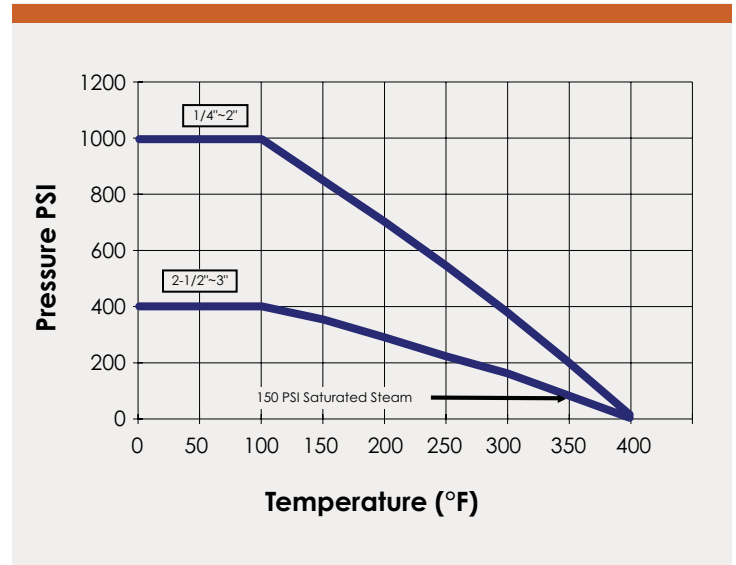

Design Features

- Blow-out proof stem
- Pressure balance hole ball slot
- Full Port
- Various threaded standards available
- Locking device is available upon request

Applicable Standards

- Design: ASME/ANSI B16.34 EN12516
- Wall thickness: ASME/ANSI B16.34 EN12516
- Pipe thread: ASME/ANSI B1.20.1
- Socket weld: ASME/ANSI B16.11
- Inspection & testing: ASME/ANSI B16.34 EN12266

V310FP Threaded				
Size	Cv	Weight (Lbs)	Port	Torques (Lbs)
1/4"	6	0.69	0.43	36
3/8"	7	0.68	0.50	36
1/2"	10	1.03	0.63	40
3/4"	25	1.28	0.77	65
1"	35	2.47	0.98	100
1-1/4"	46	3.35	1.26	155
1-1/2"	80	4.36	1.50	185
2"	110	7.58	1.97	225
2-1/2"	310	14.17	2.56	420
3"	360	21.76	3.15	1380

SWV310FP Socket Weld				
Size	Cv	Weight (Lbs)	Port	Torques (Lbs)
1/2"	10	0.99	0.63	40
3/4"	25	1.28	0.77	65
1"	35	2.40	0.98	100
1-1/4"	46	3.30	1.26	155
1-1/2"	80	4.28	1.50	185
2"	110	7.46	1.97	225
2-1/2"	310	13.29	2.56	420
3"	360	20.76	3.15	1380

LEARN MORE



800.726.9800

Follow us on [f](#) [X](#) [in](#) [@](#) [v](#) [p](#)

Headquarters: One Merit Drive, PO Box 43127, Cleveland, OH 44143

www.meritbrass.com
www.mbwebxpress.com
contactus@meritbrass.com

STAINLESS STEEL VALVES

3-PC Stainless Steel Ball Valve – Full Port 1000 WOG

V310FP/SWV310FP

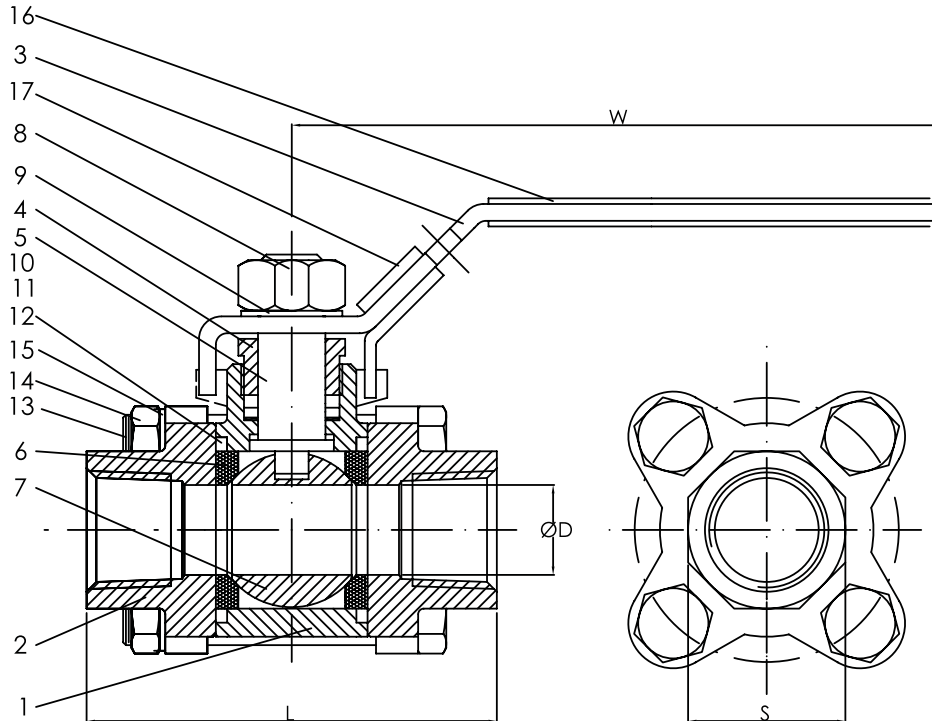

Unit: Inch

NO.	Part Name	Qty.	Material		
1	Body	1	ASTM	A351	CF8M
2	End Cap	2	ASTM	A351	CF8M
3	Handle	1	SUS 304		
4	Gland	1	SUS 304		
5	Stem	1	SUS 316		
6	Seat Ring	2	Teflon		
7	Ball	1	SUS 316		
8	Handle Nut	1	SUS 304		
9	Spring Washer	1	SUS 304		
10	Thrust Washer	1.2	Teflon		
11	Thrust Washer	1	Teflon		
12	Seal Washer	2	Teflon		
13	Bolts	4	SUS 304		
14	Nut	4	SUS 304		
15	Spring Washer	4	SUS 304		
16	Handle Cover	1	Plastic		
17	Locking Device	1	SUS 304		

Size	D Port	S	L	W	H
1/4"	0.43	0.87	2.17	3.80	1.70
3/8"	0.50	0.87	2.17	3.80	1.70
1/2"	0.63	1.06	2.52	4.25	2.05
3/4"	0.77	1.30	2.91	4.25	2.15
1"	0.98	1.58	3.31	7.01	2.68
1-1/4"	1.26	1.97	3.78	7.01	2.87
1-1/2"	1.50	2.21	4.13	7.01	3.05
2"	1.97	2.76	4.84	7.01	3.43
2-1/2"	2.56	3.43	5.98	9.61	4.72
3"	3.15	3.94	6.85	9.61	5.16