

STAINLESS STEEL VALVES

Class 200 Stainless Steel Swing Check Valve – Threaded, Full Port, “V” Series

VSC102



Applicable Standards

- Design: ASME B16.34
- Testing: API 598
- 200 PSI Working Pressure at 350°F

Size	Cv	Weight (Lbs)	Port
1/4"	5.30	0.52	0.43
3/8"	5.30	0.49	0.43
1/2"	6.90	0.62	0.59
3/4"	16.30	1.01	0.79
1"	30	1.60	0.98
1-1/4"	49	2.56	1.26
1-1/2"	70	3.40	1.50
2"	130	5.78	1.97
2-1/2"	205	12.13	2.56
3"	306	15.34	3.15

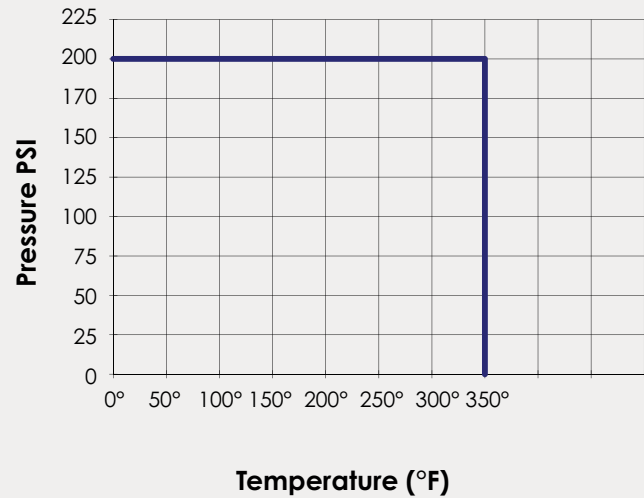

LEARN MORE



800.726.9800

Follow us on [f](#) [X](#) [in](#) [@](#) [v](#) [p](#)

Headquarters: One Merit Drive, PO Box 43127, Cleveland, OH 44143

www.meritbrass.com

www.mbwebxpress.com

contactus@meritbrass.com

STAINLESS STEEL VALVES

Class 200 Stainless Steel Swing Check Valve – Threaded, Full Port, “V” Series

VSC102

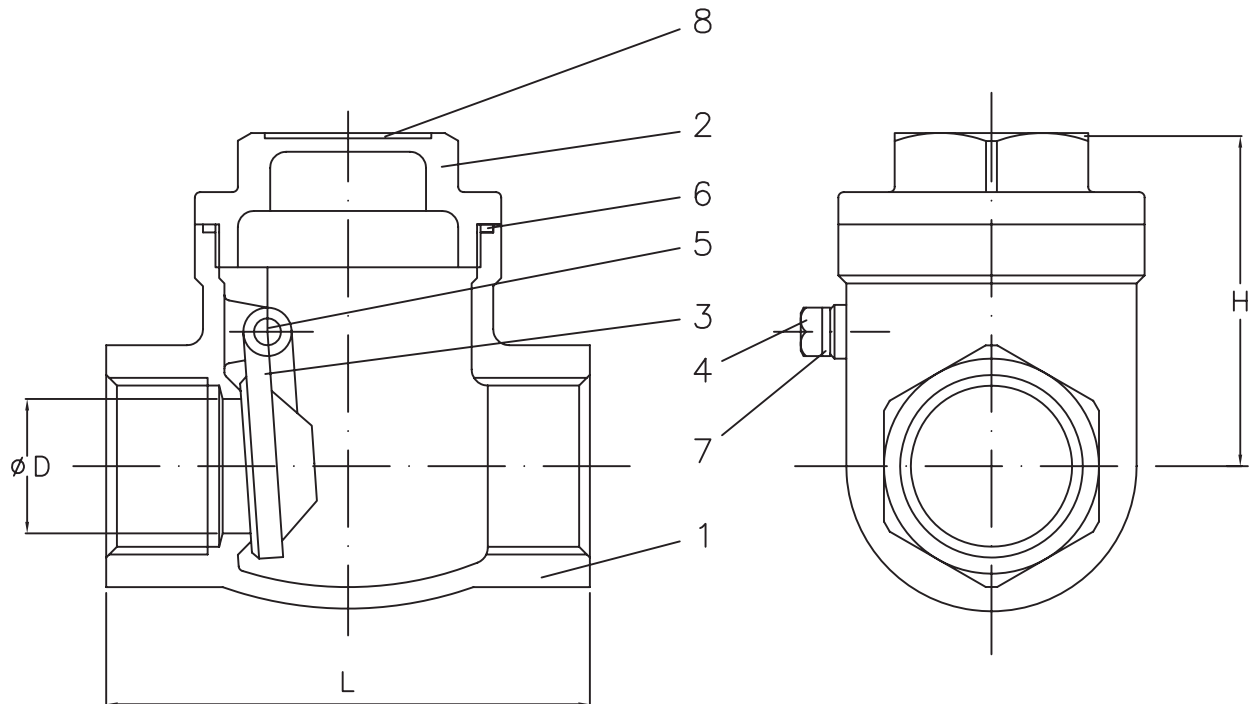

Unit: Inch

NO.	Part Name	Qty	Material		
1	Body	1	ASTM	A351	CF8M
2	Cap	1	ASTM	A351	CF8M
3	Disc	1	ASTM	A351	CF8M
4	Plug	1	SUS316		
5	Hinge Pin	1	SUS316		
6	Joint Gasket	1	Teflon		
7	Gasket	1	Teflon		
8	Name Plate	1	Aluminum		

Size	D Port	L	H
1/4"	0.43	2.36	1.63
3/8"	0.43	2.36	1.63
1/2"	0.59	2.56	1.89
3/4"	0.79	3.17	2.17
1"	0.98	3.54	2.44
1-1/4"	1.26	4.13	2.76
1-1/2"	1.50	4.72	3.15
2"	1.97	5.51	3.54
2-1/2"	2.56	7.09	4.53
3"	3.15	7.87	4.92